

INTERNAL POLYURETHANE LINING

TOOLS TO BE USED

- wire brush,
- paintbrushes,
- spatula,
- gas burner.

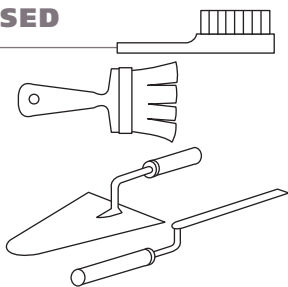

PAINT REFERENCE

EUROKOTE 4820 Ivory : 1 kg (ref. 158254)
50 ml (ref. 184727)

PROCEDURE

Clean with a wire brush to remove loose lining.

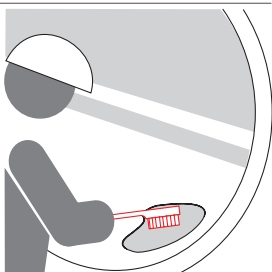

Dry the faces to be coated (they may have to be dried with a gas burner if the temperature is low and it is wet).

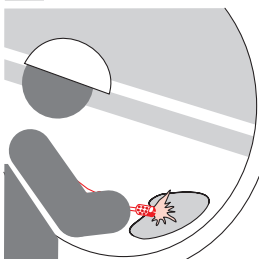

Apply the epoxy paint with a paintbrush or a spatula.

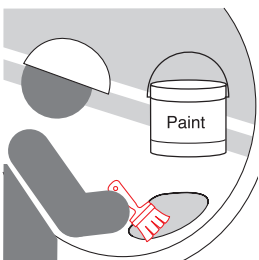

SAINT-GOBAIN PAM LAYING RECOMMENDATIONS

- STORAGE
- HANDLING
- BACKFILL
- STANDARD JOINT
- STANDARD Vi JOINT
- STANDARD Ve JOINT
- UNIVERSAL Vi JOINT
- STANDARD V+i JOINT
- UNIVERSAL Ve JOINT DN 100 to 1200 MM
- EXPRESS JOINT
- EXPRESS Vi JOINT
- PIPE CUTTING
- WELD BEAD
- ANCHOR BLOCKS
- ANCHORING
- EXTERNAL COATING REPAIRS
- INTERNAL LINING REPAIRS
- PE SLEEVE INSTALLATION
- HYDRAULIC TESTING
- ASSEMBLY EQUIPMENT
- HORIZONTAL DIRECTIONAL DRILLING
- CONTACTS

SAINT-GOBAIN
PAM

MARKETING DEPARTMENT
21 AVENUE CAMILLE CAVALLIER
54705 PONT A MOUSSON CEDEX
FRANCE
TEL: 03.83.80.73.50
www.pamline.fr

These recommendations are based upon our knowledge of the products and their use. It is the contractor's responsibility to ensure that installation is carried out according to the best rules of practice.

PAM

LAYING RECOMMENDATIONS

Internal lining repairs

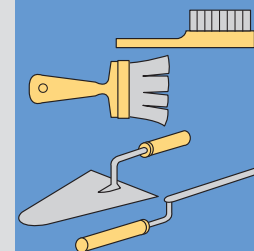

SAINT-GOBAIN
CANALISATION

AEP-MEM-15A VERSION 2007 - 4000 EX

WITH CEMENT MORTAR

TOOLS TO BE USED

- wire brushes,
- paintbrushes,
- trowel,
- mortar board,
- repair products.

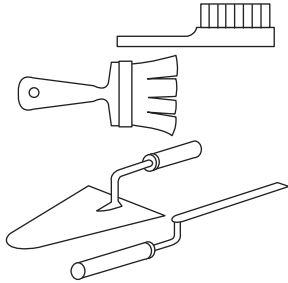

MIX PREPARATION

Proportions by weight

Cement (adapted to water or sewage)	100
Fine sand	200
Emulsion (50/50) water PRIMAL or ICOMENT	15
Water	20

Mix the two dry constituents then the two liquids to obtain a mortar with a consistency of paste.

Possibly adjust the quantity of water.

PROCEDURE

Turn the area to be repaired to face upwards.

Remove the damaged parts by cutting off edges perpendicular to iron pipe wall.

Clean it with a wire brush to remove loose parts.

Wet the area to be repaired. Wet round the edges of the area to be repaired a few minutes before making the repairs.

Prepare the mix as shown opposite.

Apply the mortar compacting it to get the correct thickness.

Smooth the surface.

Apply one extra protective coat (water and emulsion) to prevent the cement from drying out too quickly. Cover it with a damp cloth.

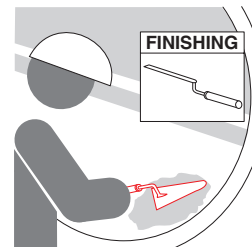
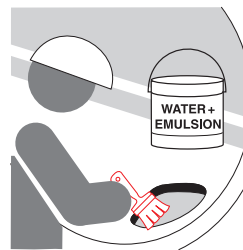

WITH EPOXY CEMENT

PACKAGING (SIDAKUR 31 DW)

6 kg Kit (ref. 158009).

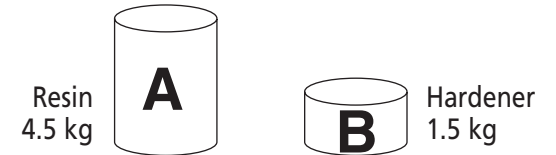

MIX PREPARATION

Proportions by weight

3 parts of A (resin) and
1 part of B (hardener)

! Only prepare the required quantity; mix it thoroughly.

PROCEDURE

Preferably **turn** the area to be repaired to face upwards.

Remove the damaged parts by cutting off edges perpendicular to iron pipe wall.

Clean it with a wire brush to remove loose parts.

Apply the mix compacting it to get the correct thickness.

Smooth the surface.

