

Manhole cover PAMREX 800 Safety E600 Class



Cover	Version	Frame	AxB (mm)	C (mm)	O (mm)	H (mm)	h (mm)	Total Mass (kg)	Cover mass (kg)	Packaging	References
Non ventilated		Square	1008x926	1000	800	126	119	136.500	79	5	CEPA80MZ
Non ventilated	with arm spring	Square	1008x926	1000	800	126	119	138.500	79	5	CEPA80MZ37
Ventilated		Square	1008x926	1000	800	126	119	136.500	79	5	CEPA80PZ
Ventilated	with arm spring	Square	1008x926	1000	800	126	119	138.500	79	5	CEPA80PZ37

(*) opening assisted with arm spring

Cover	Version	Frame	A (mm)	C (mm)	O (mm)	H (mm)	h (mm)	Total Mass (kg)	Cover mass (kg)	Packaging	References
Non ventilated		Round	1008	1000	800	126	119	126.000	79	5	CEPA80EZ
Non ventilated	with arm spring	Round	1008	1000	800	126	119	128.000	79	5	CEPA80EZ37
Ventilated		Round	1008	1000	800	126	119	126.000	79	5	CEPA80FZ
Ventilated	with arm spring	Round	1008	1000	800	126	119	128.000	79	5	CEPA80FZ37

(*) opening assisted with arm spring

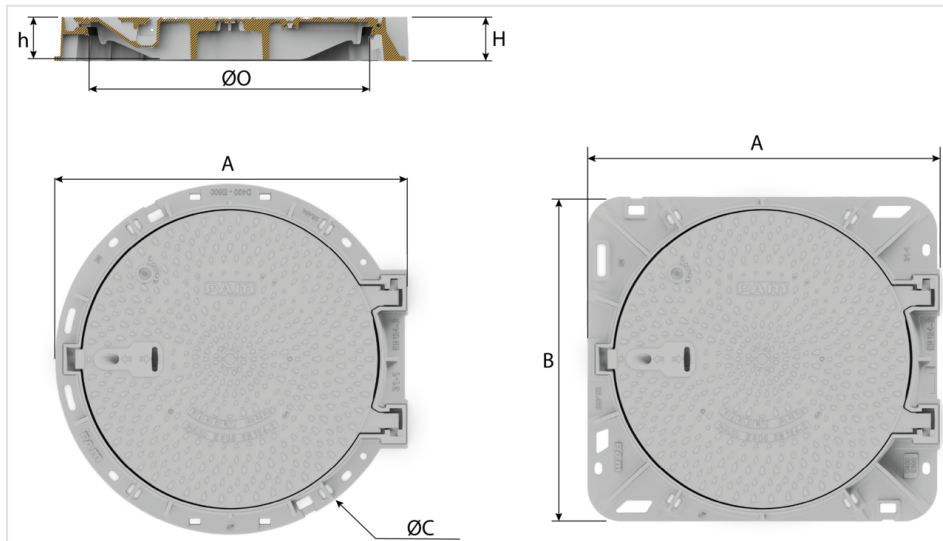

Material and coating:

- Frame in Ductile Iron EN GJS 500-7: bituminous coating
- Cover in Ductile Iron EN GJS 400-15: water base coating
- Ceramic and epoxy-coated gas assistance
- [Elastomer gasket](#)

Field of application:

- Class E600 (group 5) according to EN124-2, areas with high axle loads, e.g. docks, aircraft pavements.

Main characteristics:

- [Hinged cover and ergonomic handling box](#)
- Frame fitted for optimized bedding
- Opens to 120°, blocks at 90° when closing
- Ergonomic opening facilitated by crowbar or [C24 Operating tool](#)
- Frame compatible with the INSTALL PLUS anchoring solution

Conformity:

Saint-Gobain PAM attests that:

- the above mentioned products are manufactured in compliance with specifications, materials & characteristics as per EN124-2 : 2015 standard
- the features and performances of the above mentioned products are controlled and comply with requirements of EN124-1 : 2015 standard

The PAM brand affixed on these related products materialises this attestation of conformity.

Security



- [Optional ¼-turn lock](#) for operator safety, operable from the inside
- [Gas-assisted opening/closing \(option\)](#) :
 - Improved assistance and stability of closed cover
 - Assistance can be installed when frame is already bedded
- Lockable from inside

[Assembling instructions C126](#): Gas arm assistance kit PAMREX 800

Accessories



Accessories for Manhole Covers: operating key C24 for PAMREX, VIATOP and VIATOP 2 Manhole covers



PAMREX / VIATOP manhole covers

Linked products



Elastomer Ring



Anti-theft pins for PAMREX / VIATOP 600 and 700 / VIATOP 2 manhole cover

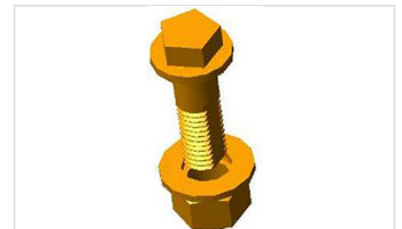

1/4 turn locks

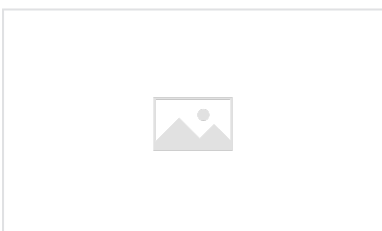

Identification of PAMREX manhole covers versions



PAMREX MANHOLE COVERS

07/11/2025
ME60MCNPMX500

The information on this sketch is, to the best of our knowledge correct at the time of printing. However Saint-Gobain are constantly looking at ways of improving their products and services therefore reserve the right to change without prior notice, any of the data shown. Any orders placed will be subject to our Standard Conditions of Sale, available on request.

