

PRODUCT DATASHEET

RECOMMENDED FOR USE IN:

Carriageways carrying continuous traffic where frequent access to below ground assets and proven skid resistant performance is required.

GripTop Ult-Emax offers a permanent high friction solution for where road design or configuration requires a product that demonstrates higher anti-skid properties such as the approaches to pedestrian crossings, traffic lights, roundabouts and junctions.



DURABILITY

Includes the Load Transfer System (LTS) for optimum installation and product durability



SECURITY

Integral automatic spring bar locking feature to deter unauthorised access offering increased asset security



HEALTH & SAFETY

Individually hinged cover sections ensuring safe operation by reducing the effort required when opening and closing



PERFORMANCE

Three point suspension ensures non-rock and silent in operation performance



ACCREDITATION

Third party certified by BSI and kite marked to the requirements of BS EN 124. Compliant to the requirements of Highways England advice note HA104/09



ROAD SAFETY

Exceeds the requirements as stated within paragraph 3.4 of Chapter 3: Design Considerations for Chamber Tops within HA104/09. The PSRV has been independently verified in accordance with the requirements and methodology stated within BS9124



SAVE TIME & COST

Available with the Install Plus frame levelling and installation system as standard

PRODUCT DATASHEET

GRIP TOP ULT-EMAX D400 HIGH FRICTION ACCESS COVER RANGE

SAP CODE	BS EN 124 CLASS	CLEAR OPENING A x B (mm)	OVER BASE C x D (mm)	DEPTH E (mm)	MASS OF COVER (kg)	TOTAL MASS (kg)	BEARING PRESSURE (N/mm ²)	PALLET QUANTITY	PREVIOUS REF.
212933	D400	600 x 600	806 x 806	100	25.9 / 19.4	82.2	1.82	10	MG06 1B
212935	D400	600 x 600	806 x 806	150	25.9 / 19.4	92.1	2.02	10	MG14 1B
212934	D400	675 x 675	880 x 830	100	26.2 / 19.9	98.5	1.83	10	MG22 1B
212936	D400	675 x 675	880 x 830	150	26.2 / 19.9	109.5	1.96	5	MG30 1B

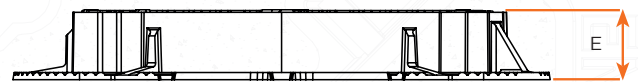
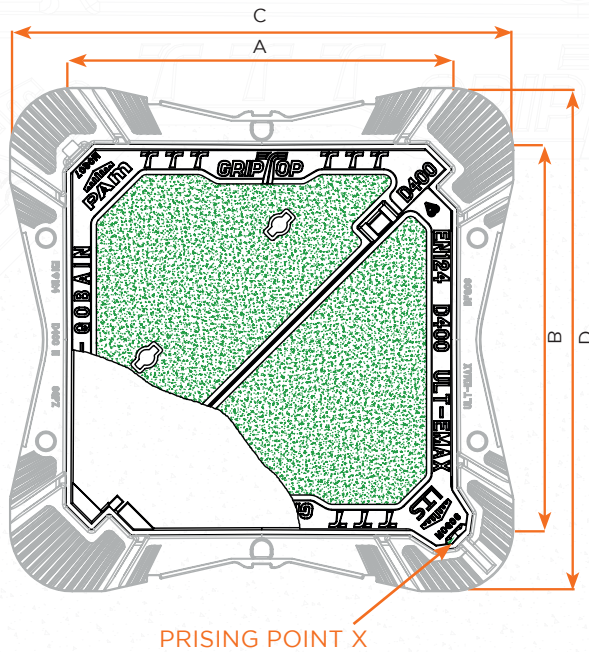

Primary Cover is locked closed with a Spring Arm, but once released, can be rotated upwards to 110° for inspection purposes. Both covers should be removed for Entry.

For details of the standard Ult-Emax range please refer to data sheet SGPUK003
Produced at Holwell Works, UK

The information on this sketch is, to the best of our knowledge correct at the time of printing. However Saint-Gobain are constantly looking at ways of improving their products and services therefore reserve the right to change without prior notice, any of the data shown. Any orders placed will be subject to our Standard Conditions of Sale, available on request.
COPYRIGHT AND DESIGN RIGHT

This drawing is the exclusive property of Saint-Gobain PAM UK and is confidential and must not be reproduced or disclosed for any third party without written consent. It must be used only for the purpose for which it has been issued and is returnable on request.