

Through Bore-CE Fire Hydrant

DN80, PN16

Through Bore-CE Underground Fire Hydrant to BS 750:2012 and BS EN 14339 Certificate No. KM 31556. CE Marked in accordance with Construction Products Directive; Certificate No. 0086-CPR-551050.

Main features

- Kitemarked to BS750:2012, EN1074-1/2&6 and BS EN 14339
- Unobstructed 80mm full bore access when outlet cap removed
- Patented design
- Robust design with minimal maintenance requirements - safety factor of 2.6
- Automatic frost valve - no water escape during operation
- Secure bolted bonnet to enable easy maintenance

Technical information

- Clockwise close
- Weight 16 kg
- Maximum operating temperature 60°C
- MOT 105 Nm
- MST 210 Nm
- $K_v > 92 \text{ m}^3/\text{hour}$ - actual 245 m^3/hour
- Drainage system - time to drain 10 minutes
- Volume retained water 70ml
- Number of turns to
 - start flow 2
 - fully open 11

Options

- PN16 (standard)
- Bayonet outlet (UK or Dublin)
- N.I. Belfast outlet

- Low weight compact design for ease of handling and installation
- Universal inlet flange
- Ductile iron corrosion resistant construction
- All non-metallic parts are in accordance with BS 6920-1; WRAS approved
- Fixed obturator to BS EN1074-6
- Stainless steel bolts (standard)
- 2½" London round thread stainless steel outlet (standard) to BS 750:2012

- Hydrant for potable water systems to BS EN 1074-6
- Resistance to disinfection to BS EN 1074-6
- Blue fusion bonded epoxy coating 250 microns to WIS 4-52-01; WRAS approved
- Inlet flange suitable for connections to BS EN 1092-2 PN10/16 & BS 10 table D & E
- Stem seals and stem cap to BS750:2012



Technical Features

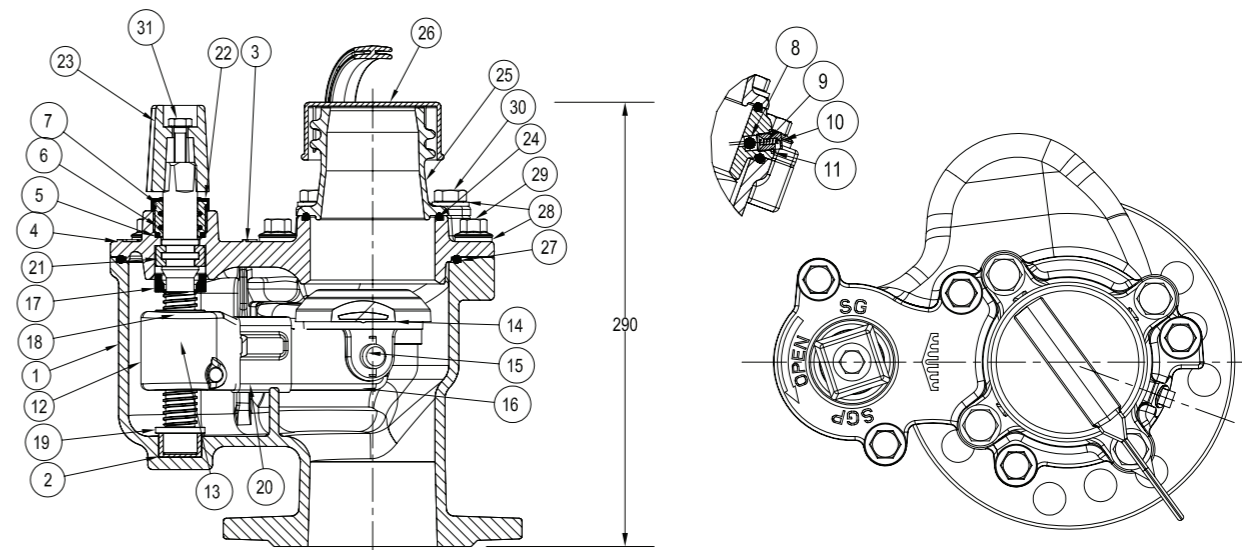

Materials

Ref	Description	Material	Standard
1	HYDRANT BODY	Ductile Iron EN-GJS 500/7	BS EN 1563-3
2	BEARING	Brass CW 614 N	BS EN 12164
3	BONNET ASSEMBLY PROTECTION	EPDM	BS EN 681-1
4	HYDRANT BONNET	Ductile Iron EN-GJS 500/7	BS EN 1563-3
5	O RING Ø26xØ3	EPDM	BS EN 681-1
6	O RING Ø32xØ3.5	EPDM	BS EN 681-1
7	SEALING NUT	LG2 Gunmetal	BS 1470
8	FROST VALVE BALL	EPDM	BS EN 681-1
9	FROST VALVE SPRING	Stainless Steel grade 1.4310	BS EN 10088-3
10	FROST VALVE NUT	Brass CW 614 N	BS EN 12164
11	O RING	EPDM	BS EN 681-1
12	ARM ASSEMBLY PROTECTION	EPDM	BS EN 681-1
13	OBTURATOR/GATE ARM	Ductile Iron EN-GJS 500/7	BS EN 1563-3
14	OBTURATOR/GATE/PISTON	EPDM	BS EN 681-1
15	OBTURATOR PIN	Stainless Steel grade 1.4021	BS EN ISO 3506
16	SPLIT PIN Ø5x28	Stainless Steel grade 1.4021	BS EN ISO 1234
17	GASKET	EPDM	BS EN 681-1
18	SPINDLE	Stainless Steel grade 1.4027	BS EN 10088-3
19	BEARING	Stainless Steel grade 1.4021	BS EN 10088-3
20	ARM ASSEMBLY PROTECTION	EPDM	BS EN 681-1
21	LIMITER	Brass CW 614 N	BS EN 12164
22	GASKET	EPDM	BS EN 681-1
23	OPERATING CAP	Ductile Iron EN-GJS 500/7	BS EN 1563-3
24	OUTLET GASKET	EPDM	BS EN 681-1
25	SCREWED OUTLET	Stainless Steel grade 1.4027	BS EN 10088-3
26	OUTLET COVER	HDPE	—
27	BONNET GASKET	EPDM	BS EN 681-1
28	WASHER A12	Stainless Steel grade A2	BS EN ISO 3506
29	SCREW M12x30	Stainless Steel grade A2-70	BS EN ISO 4017
30	SCREW M12x35	Stainless Steel grade A2-70	BS EN ISO 4017
31	SCREW M8x35	Stainless Steel grade A2-70	BS EN ISO 4017

