

### Cono (PECB) con 2 Bridas Fijas

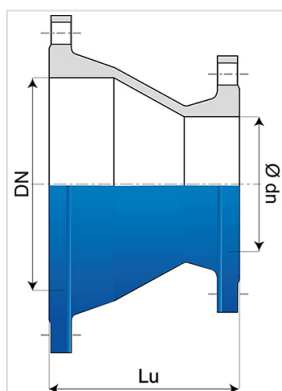

| DN (mm) | Ødn (mm) | Lu (mm) | PN 10     |             | PN 16     |             | PN 25     |             | PN 40     |             |
|---------|----------|---------|-----------|-------------|-----------|-------------|-----------|-------------|-----------|-------------|
|         |          |         | Peso (kg) | Referencias | Peso (kg) | Referencias | Peso (kg) | Referencias | Peso (kg) | Referencias |
| 80      | 40       |         | 6,60      | BBA80VE1ATT | 6,60      | BBA80VE1ATT | 6,60      | BBA80VE1ATT | 6,60      | BBA80VE1ATT |
| 80      | 50       | 200     | 8,70      | BBA80VE1BTT | 8,70      | BBA80VE1BTT | 8,70      | BBA80VE1BTT | 8,70      | BBA80VE1BTT |
| 80      | 65       | 200     | 7,90      | BBA80VE1DTT | 7,90      | BBA80VE1DTT | 7,90      | BBA80VE1DTT | 7,90      | BBA80VE1DTT |
| 100     | 40       |         | 11,50     | BBB10VE1ATT | 11,50     | BBB10VE1ATT |           |             |           |             |
| 100     | 50       | 200     | 8,60      | BBB10VE1BTT | 8,60      | BBB10VE1BTT | 9,60      | BBB10VE3BTT | 9,60      | BBB10VE3BTT |
| 100     | 65       | 205     | 8,70      | BBB10VE1DTT | 8,70      | BBB10VE1DTT |           |             |           |             |
| 100     | 80       | 200     | 9,50      | BBB10VE1ETT | 9,50      | BBB10VE1ETT | 9,80      | BBB10VE3ETT | 9,80      | BBB10VE3ETT |
| 125     | 80       | 200     | 10,50     | BBB12VE1ETT | 10,50     | BBB12VE1ETT |           |             |           |             |
| 125     | 100      | 200     | 11,40     | BBB12VE1FTT | 11,40     | BBB12VE1FTT |           |             |           |             |
| 150     | 80       | 200     | 12,00     | BBB15VE1ETT | 12,00     | BBB15VE1ETT |           |             |           |             |
| 150     | 100      | 200     | 14,90     | BBB15VE1FTT | 14,90     | BBB15VE1FTT | 15,70     | BBB15VE3FTT | 15,70     | BBB15VE3FTT |
| 150     | 125      | 200     | 14,00     | BBB15VE1GTT | 14,00     | BBB15VE1GTT |           |             |           |             |
| 200     | 80       | 300     | 18,00     | BBB20VE1ETT | 23,00     | BBB20VE2ETT |           |             |           |             |
| 200     | 100      | 300     | 36,20     | BBB20VE1FTT | 36,20     | BBB20VE2FTT |           |             |           |             |
| 200     | 125      |         | 20,50     | BBB20VE1GTT | 20,50     | BBB20VE2GTT |           |             |           |             |
| 200     | 150      | 300     | 21,80     | BBB20VE1JTT | 21,80     | BBB20VE2JTT | 25,00     | BBB20VE3JTT |           |             |
| 250     | 80       | 600     | 23,00     | BBB25VE1ETT | 32,00     | BBB25VE2ETT |           |             |           |             |
| 250     | 100      | 300     | 40,00     | BBB25VE1FTT | 40,00     | BBB25VE2FTT |           |             |           |             |
| 250     | 150      | 300     | 40,00     | BBB25VE1JTT | 52,00     | BBB25VE2JTT | 31,00     | BBB25VE3JTT |           |             |
| 250     | 200      | 300     | 30,00     | BBB25VE1KTT | 47,00     | BBB25VE2KTT | 35,50     | BBB25VE3KTT |           |             |
| 300     | 80       | 700     |           |             | 43,00     | BBB30VE2ETT |           |             |           |             |

| DN (mm) | Ødn (mm) | Lu (mm) | PN 10     |             | PN 16     |             | PN 25     |             | PN 40     |             |
|---------|----------|---------|-----------|-------------|-----------|-------------|-----------|-------------|-----------|-------------|
|         |          |         | Peso (kg) | Referencias | Peso (kg) | Referencias | Peso (kg) | Referencias | Peso (kg) | Referencias |
| 300     | 100      | 300     | 29,50     | BBB30VE1FTT | 31,00     | BBB30VE2FTT |           |             |           |             |
| 300     | 150      | 300     | 60,70     | BBB30VE1JTT | 60,70     | BBB30VE2JTT |           |             |           |             |
| 300     | 200      | 300     | 37,50     | BBB30VE1KTT | 58,00     | BBB30VE2KTT |           |             |           |             |
| 300     | 250      | 300     | 72,00     | BBB30VE1LTT | 72,00     | BBB30VE2LTT |           |             |           |             |
| 350     | 200      | 600     | 50,00     | BBB35VE1KTT | 50,00     | BBB35VE2KTT |           |             |           |             |
| 350     | 250      | 300     | 58,00     | BBB35VE1LTT | 58,00     | BBB35VE2LTT |           |             |           |             |
| 350     | 300      | 300     | 50,00     | BBB35VE1MTT | 52,50     | BBB35VE2MTT |           |             | 92,00     | BBB35VE4MTT |
| 400     | 200      | 300     | 48,50     | BBB40VE1KTT | 71,00     | BBB40VE2KTT |           |             | 107,00    | BBB40VE4KTT |
| 400     | 250      | 300     | 84,00     | BBB40VE1LTT | 69,50     | BBB40VE2LTT | 69,50     | BBB40VE3LTT |           |             |
| 400     | 300      | 300     | 113,50    | BBB40VE1MTT | 68,00     | BBB40VE2MTT | 113,50    | BBB40VE3MTT |           |             |
| 400     | 350      | 300     | 59,00     | BBB40VE1YTT | 67,00     | BBB40VE2YTT |           |             |           |             |
| 450     | 250      | 600     |           |             | 87,50     | BBB45VE2LTT |           |             |           |             |
| 450     | 300      | 600     |           |             | 95,00     | BBB45VE2MTT |           |             |           |             |
| 450     | 350      | 600     |           |             | 104,00    | BBB45VE2YTT |           |             |           |             |
| 450     | 400      | 300     |           |             | 81,00     | BBB45VE2NTT |           |             |           |             |
| 500     | 250      | 700     | 100,00    | BBB50VE1LTT | 138,00    | BBB50VE2LTT |           |             |           |             |
| 500     | 300      | 600     | 118,00    | BBB50VE1MTT | 147,00    | BBB50VE2MTT |           |             |           |             |
| 500     | 350      | 600     |           |             | 132,90    | BBB50VE2YTT |           |             |           |             |
| 500     | 400      | 600     | 127,00    | BBB50VE1NTT | 150,00    | BBB50VE2NTT |           |             | 205,00    | BBB50VE4NTT |
| 500     | 450      | 600     | 187,00    | BBB50VE1PTT | 189,00    | BBB50VE2PTT | 216,00    | BBB50VE3PTT |           |             |
| 600     | 300      | 800     | 172,00    | BBB60VE1MTT | 166,00    | BBB60VE2MTT |           |             |           |             |
| 600     | 350      | 700     |           |             | 196,00    | BBB60VE2YTT |           |             |           |             |
| 600     | 400      | 600     | 135,00    | BBB60VE1NTT | 164,00    | BBB60VE2NTT | 247,00    | BBB60VE3NTT |           |             |
| 600     | 450      | 600     | 223,00    | BBB60VE1PTT | 230,00    | BBB60VE2PTT | 263,00    | BBB60VE3PTT |           |             |
| 600     | 500      | 600     | 149,00    | BBB60VE1QTT | 190,00    | BBB60VE2QTT |           |             |           |             |
| 700     | 400      | 600     | 200,00    | BBB70VE1NTT | 220,00    | BBB70VE2NTT |           |             |           |             |
| 700     | 450      | 700     |           |             | 285,00    | BBB70VE2PTT |           |             |           |             |
| 700     | 500      | 600     | 281,00    | BBB70VE1QTT | 266,00    | BBB70VE2QTT | 328,00    | BBB70VE3QTT |           |             |
| 700     | 600      | 600     | 218,00    | BBB70VE1RTT | 243,00    | BBB70VE2RTT | 246,00    | BBB70VE3RTT |           |             |
| 800     | 500      | 800     | 500,00    | BBB80VE1QTT | 480,50    | BBB80VE2QTT |           |             |           |             |
| 800     | 600      | 600     | 345,00    | BBB80VE1RTT | 354,00    | BBB80VE2RTT | 415,00    | BBB80VE3RTT |           |             |
| 800     | 700      | 600     | 272,00    | BBB80VE1STT | 269,00    | BBB80VE2STT |           |             |           |             |
| 900     | 700      | 600     | 440,00    | BBB90VE1STT | 414,00    | BBB90VE2STT |           |             |           |             |

| DN (mm) | Ødn (mm) | Lu (mm) | PN 10     |             | PN 16     |             | PN 25     |             | PN 40     |             |
|---------|----------|---------|-----------|-------------|-----------|-------------|-----------|-------------|-----------|-------------|
|         |          |         | Peso (kg) | Referencias | Peso (kg) | Referencias | Peso (kg) | Referencias | Peso (kg) | Referencias |
| 900     | 800      | 600     | 337,00    | BBB90VE1TTT | 359,00    | BBB90VE2TTT | 448,00    | BBB90VE3TTT |           |             |
| 1000    | 800      | 600     | 570,00    | BBC10VE1TTT | 520,00    | BBC10VE2TTT | 693,00    | BBC10VE3TTT |           |             |
| 1000    | 900      | 600     | 415,00    | BBC10VE1UTT | 447,00    | BBC10VE2UTT |           |             |           |             |
| 1200    | 600      | 1495    | 870,00    | BBC12VE1RTT | 980,00    | BBC12VE2RTT | 1054,00   | BBC12VE3RTT |           |             |
| 1200    | 800      | 1290    | 779,00    | BBC12VE1TTT | 812,00    | BBC12VE2TTT |           |             |           |             |
| 1200    | 1000     | 860     | 656,00    | BBC12VE1VTT | 717,00    | BBC12VE2VTT | 886,00    | BBC12VE3VTT |           |             |
| 1400    | 1200     | 760     | 846,00    | BBC14VE1BTT | 955,00    | BBC14VE2BTT |           |             |           |             |
| 1500    | 1200     | 760     |           |             | 1032,00   | BBC15VE2BTT |           |             |           |             |
| 1500    | 1400     | 570     |           |             | 966,00    | BBC15VE2CTT |           |             |           |             |
| 1600    | 1200     | 1085    | 1194,00   | BBC16VE1BTT | 1245,00   | BBC16VE2BTT | 1561,00   | BBC16VE3BTT |           |             |
| 1600    | 1400     | 890     | 1259,00   | BBC16VE1CTT | 1309,00   | BBC16VE2CTT | 1586,00   | BBC16VE3CTT |           |             |
| 1600    | 1500     | 890     | 1169,00   | BBC16VE1DTT | 1344,00   | BBC16VE2DTT |           |             |           |             |
| 1800    | 1600     | 970     | 1626,00   | BBC18VE1ETT |           |             |           |             |           |             |
| 2000    | 1800     | 1030    | 2049,00   | BBC20VE1FTT |           |             |           |             |           |             |
| 2000    | 1400     | 1630    |           |             | 2716,00   | BBC20VE2CTT |           |             |           |             |
| 2000    | 1600     | 1350    |           |             | 2458,00   | BBC20VE2ETT |           |             |           |             |

(\*) consúltenos

### Campo de empleo:

- Para redes de abastecimiento de agua potable.

### Características principales:

- Revestimiento exterior e interior: empolvado de epoxi color azul de espesor medio 250 micras de forma que el espesor mínimo medio de la capa no sea inferior a 200 µm., de acuerdo con la norma EN 14901-1 (PECB)
- En conformidad con las normas ISO 2531/EN545

## Productos vinculados

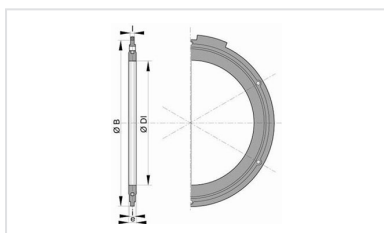

Junta a bridas con bulones  
en acero galvanizado