

## Joint UNI STD Vi pour Tuyaux et Raccords INTEGRAL DN80-700

Rondelle Standard

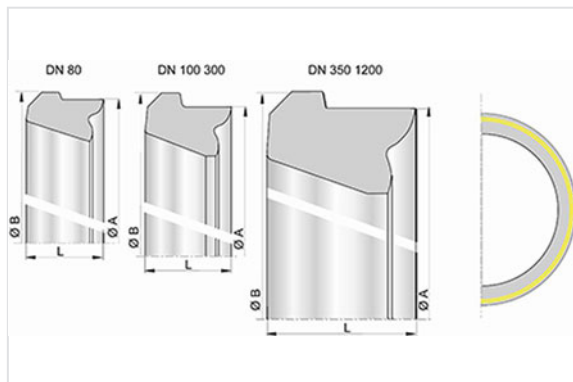

Bague de verrouillage Standard Universal Vi

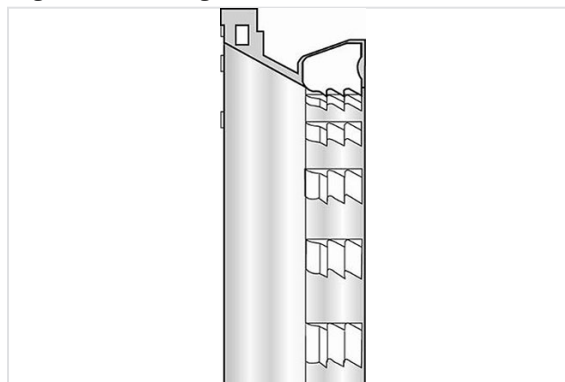

Le joint STANDARD UNIVERSAL VI est un joint automatique à inserts métalliques noyés dans la bague de verrouillage.

### Composition des ensembles

DN mm	Masse bague de verrouillage kg	Référence bague de verrouillage	Masse bague de joint kg	Référence bague de joint
80	0.150	ANA80CA6	0.156	JSA80BB
100	0.200	ANB10CA6	0.207	JSB10BB
125	0.260	ANB12CA6	0.257	JSB12BB
150	0.310	ANB15CA5	0.300	JSB15BB
200	0.490	ANB20CA4	0.405	JSB20BB
250	0.610	ANB25CA4	0.524	JSB25BB
300	0.780	ANB30CA4	0.749	JSB30BB
350	1.470	JNB35CA	0.945	JSB35BB
400	1.700	JNB40CA	1.134	JSB40BB
450	1.870	JNB45CA	1.393	JSB45BB
500	2.540	JNB50CA	1.626	JSB50BB
600	3.000	JNB60CA	2.276	JSB60BB
700	3.660	110053	3.022	JSB70BB

## Produits associés

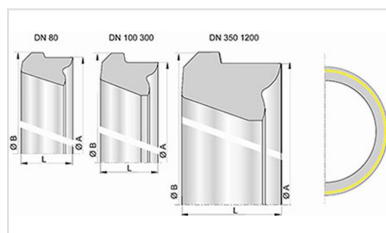

Bague de joint STD Nitrile  
DN80-2000

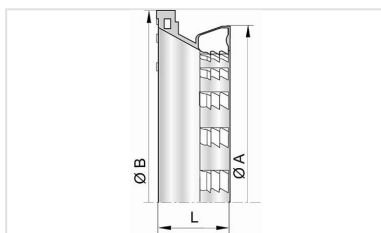

Bague de verrouillage UNI  
Vi DN80-700