

### Coude 90° (1/4) (PECB) à 2 Brides Orientables

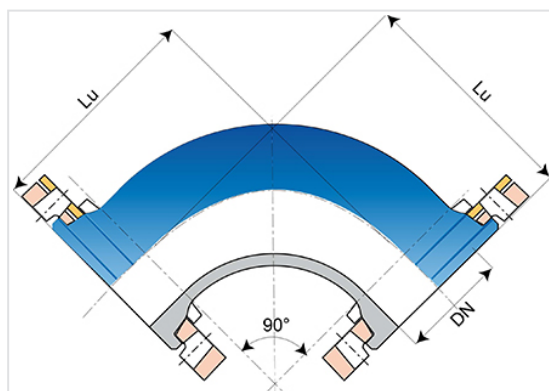

| Angle | DN (mm) | Lu (mm) | PN 10      |              | PN 16      |              | PN 25      |              | PN 40      |             |
|-------|---------|---------|------------|--------------|------------|--------------|------------|--------------|------------|-------------|
|       |         |         | Masse (kg) | Référence    | Masse (kg) | Référence    | Masse (kg) | Référence    | Masse (kg) | Référence   |
| 90°   | 40      | 140     | 6,30       | BAA40CA10TT  | 6,30       | BAA40CA10TT  | 6,30       | BAA40CA10TT  | 6,30       | BAA40CA10TT |
| 90°   | 50      | 150     | 7,30       | BAA50CA10TT  | 7,30       | BAA50CA10TT  | 7,30       | BAA50CA10TT  | 7,30       | BAA50CA10TT |
| 90°   | 60      | 160     | 8,50       | BAA60CA10TT  | 8,50       | BAA60CA10TT  | 7,80       | BAA60CA30TT  | 7,80       | BAA60CA30TT |
| 90°   | 65      | 160     | 9,60       | BAA65CA10TT  | 9,60       | BAA65CA10TT  |            |              |            |             |
| 90°   | 80      | 165     | 11,20      | BAA80CA10TT  | 11,20      | BAA80CA10TT  | 11,20      | BAA80CA10TT  | 11,20      | BAA80CA10TT |
| 90°   | 100     | 180     | 13,00      | BAB10CA10TT  | 13,00      | BAB10CA10TT  | 14,00      | BAB10CA30TT  | 14,00      | BAB10CA30TT |
| 90°   | 125     | 200     | 17,60      | BAB12CA10TT  | 17,60      | BAB12CA10TT  | 21,40      | BAB12CA30TT  | 21,40      | BAB12CA30TT |
| 90°   | 150     | 220     | 23,00      | BAB15CA10TT  | 23,00      | BAB15CA10TT  | 25,00      | BAB15CA30TT  | 25,00      | BAB15CA30TT |
| 90°   | 200     | 260     | 37,50      | BAB20CA10TT  | 37,50      | BAB20CA20TT  | 40,50      | BAB20CA30TT  | 43,50      | BAB20CA40TT |
| 90°   | 250     | 327,5   | 49,30      | BAB25CA10TT2 | 49,30      | BAB25CA20TT2 | 54,50      | BAB25CA30TT2 |            |             |
| 90°   | 300     | 376     | 69,70      | BAB30CA10TT2 | 68,70      | BAB30CA20TT2 | 76,30      | BAB30CA30TT2 |            |             |
| 90°   | 350     | 424,5   | 94,08      | BAB35CA10TT2 | 96,39      | BAB35CA20TT2 | 108,15     | BAB35CA30TT2 |            |             |
| 90°   | 400     | 473     | 119,91     | BAB40CA10TT2 | 129,36     | BAB40CA20TT2 | 148,26     | BAB40CA30TT2 |            |             |
| 90°   | 500     | 570     | 190,05     | BAB50CA10TT2 | 217,35     | BAB50CA20TT2 | 230,00     | BAB50CA30TT2 |            |             |
| 90°   | 600     | 700     | 359,00     | BAB60CA10TT  | 409,00     | BAB60CA20TT  | 415,00     | BAB60CA30TT  |            |             |

#### Domaine d'emploi :

- Pour réseaux d'adduction d'eau potable

## Principales caractéristiques :

- Revêtement extérieur-intérieur : poudre époxy bleu 250 microns d'épaisseur moyenne avec un mini de 200 microns, conforme à la norme EN 14901-1 (PECB)
- Conformité à EN 545:2010 et ISO 2531:2009

## Produits associés

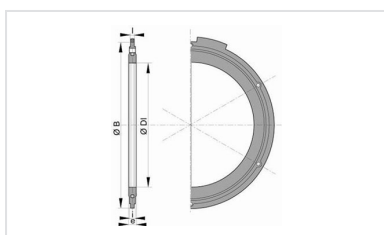

Ensemble de joint à brides  
avec boulonnerie en acier  
galvanisé à chaud