

Manhole cover VIATOP 800 Safety D400 class Square frame - Non Ventilated - Opening assisted

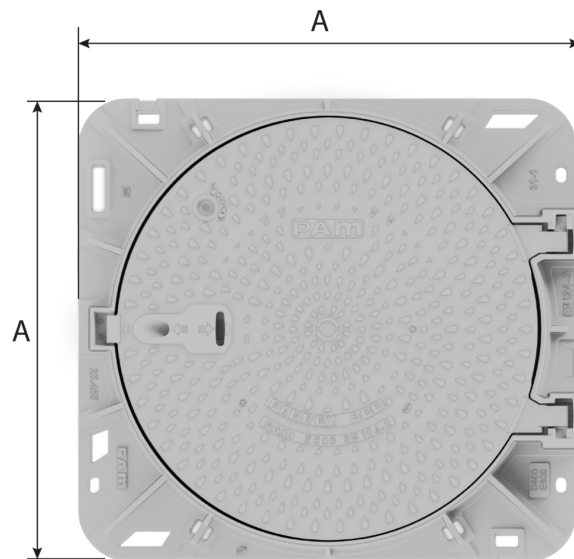

AxA (mm)	H (mm)	h (mm)	O (mm)	Total Mass (kg)	Cover mass (kg)	Packaging	References
1000x1000	125	115	800	129.50	76.2	10	CDVM80MZ37

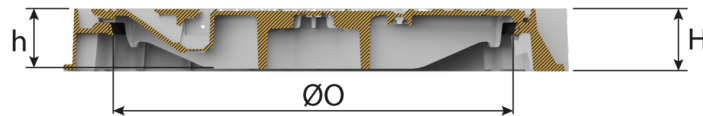

Material and coating:

- Frame and cover in Ductile Iron EN GJS 400-15: water base coating
- [Ring in elastomer](#)

Field of application:

- D400 class (Group 4) according to standard EN124-2, carriageways of roads, hard shoulders and parking areas for all types of road vehicles.
- Heavy traffic zones and frequent visits.

Main characteristics:

- [Double hinged cover and ergonomic handling box](#)
- Frame fitted for optimized bedding
- [Assistance gas arm assembled in factory](#)
- [Operating Key C24](#)

Conformity:

Saint-Gobain PAM attests that:

- the above mentioned products are manufactured in compliance with specifications, materials & characteristics as per EN124-2 : 2015 standard
- the features and performances of the above mentioned products are controlled and comply with requirements of EN124-1 : 2015 standard

The PAM brand affixed on these related products materialises this attestation of conformity.

Option:

- [Quarter turn locking system](#) (type SCS : C78 or type PENTA Plus : C76)

Accessories



VIATOP manhole covers -
Articulated cover and
ergonomic handling box



PAMREX / VIATOP 800
manhole covers with
opening assisted



PAMREX / VIATOP
manhole covers

Linked products



Elastomer Ring

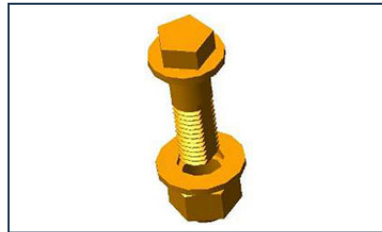

1/4 turn locks



Accessories for Manhole
Covers: operating key
C24 for PAMREX, VIATOP
and VIATOP 2 Manhole
covers

The information on this sketch is, to the best of our knowledge correct at the time of printing. However Saint-Gobain are constantly looking at ways of improving their products and services therefore reserve the right to change without prior notice, any of the data shown. Any orders placed will be subject to our Standard Conditions of Sale, available on request.