

## Manhole Cover VIATOP M NIVEAU 140 Class D400 height adjustable - Non Ventilated

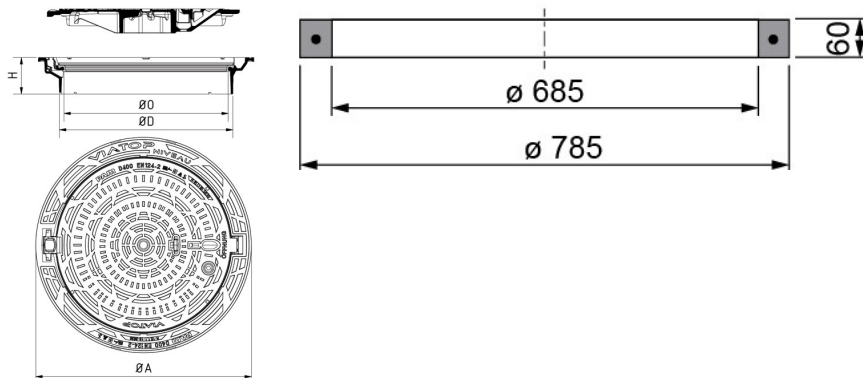

Viatop M supersedes all previous versions of CO 600mm Viatop manhole covers.

A (mm)	D (mm)	O (mm)	H (mm)	Total Mass (kg)	Cover mass (kg)	Packaging	References
830	670	610	140	81.67	47.5	5	CDVM60QGX40



## Material and coating:

- Frame and cover in Ductile Iron EN GJS 400-15: water base coating
- [Ring in elastomer](#)

## Field of application:

- D400 class (Group 4) according to standard DIN EN 124-2, carriageways of roads, hard shoulders and parking areas for all types of road vehicles.
- Heavy traffic zones and frequent visits.

## Main characteristics:

- 140mm-deep “floating” frame, height adjustable 160 up to 180mm
- Vertical frame bearing flange shape for perfect matching with surrounding road asphalt
- Wide frame flange bearing surface reducing load transmission to road asphalt
- Requires 60mm-high adapting concrete ring
- Continuous elastomeric gasket with, 2-directional disconnection between frame & cover
- Orientation of cover during installation is traffic-direction sensitive
- Rated pedestrians’ slip-resistant chequer plate
- Hinged cover opens to 100° with safety blocking at 90°
- [Hinged cover and ergonomic multi-tool handling box](#)
- Cover fittable on any previous Viatop frames
- Available markings of fields of application: SW, RW, WASSER
- Wide choice of cover customization locations & sizes (up to 80% of the surface) offered, consult sales organisations

## Security

- [Quarter turn locking system](#)
- [Mudpan for VIATOP Manhole covers](#)
- [Operating key C24](#)

## Accessories

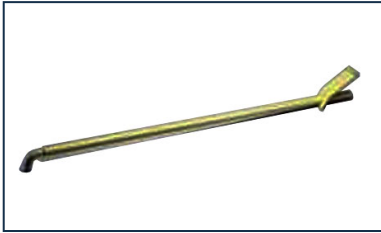

Accessories for Manhole Covers: operating key C24 for PAMREX, VIATOP and VIATOP 2 Manhole covers

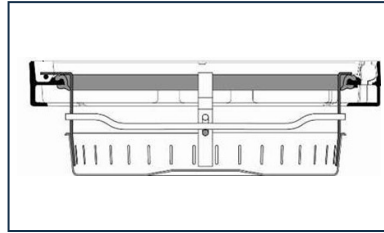

Mudpan for VIATOP/ DYNATOP Manhole covers

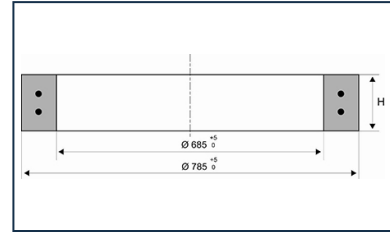

Concrete Ring for VIATOP 600 NIVEAU Manhole cover



Auxilliary formwork for VIATOP M SELFLEVEL

## Linked products



Elastomer Ring



1/4 turn locks

Last Update 08/06/2026  
Visit website for latest version

*The information on this sketch is, to the best of our knowledge correct at the time of printing. However Saint-Gobain are constantly looking at ways of improving their products and services therefore reserve the right to change without prior notice, any of the data shown. Any orders placed will be subject to our Standard Conditions of Sale, available on request.*