

### Short Double Flanged Pipe INTEGRAL with Fixed Flanges

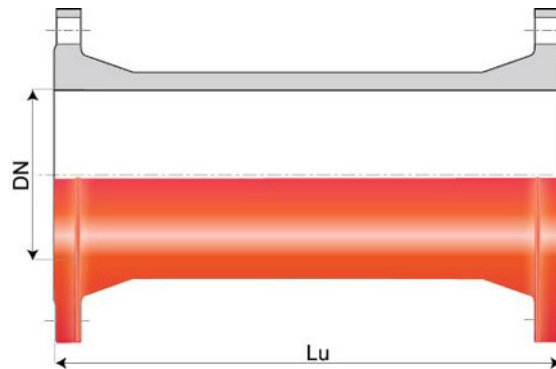

DN (mm)	Lu (mm)	PN 10		PN 16	
		Mass (kg)	References	Mass (kg)	References
200	200			21.06	BBB20MT2VFF
200	300			25.00	BBB20MT2WFF
200	400			31.50	BBB20MT2XFF
250	500	51.30	BBB25MT1BFF		
300	200			45.00	BBB30MT2VFF
300	300			45.00	BBB30MT2WFF
300	500			65.80	BBB30MT2BFF
700	500			293.00	BBB70MT2BFF
800	500			329.00	BBB80MT2BFF
1000	500			564.00	BBC10MT2BFF
1200	500			696.70	BBC12MT2BFF

### Field of use:

- Separate sewer system and combined sewer system
- Application: gravity flow and rising main sewerage systems
- Type of effluent: domestic wastewater and rainwater
- For networks with rising main under pressure
- For effluents between pH1 and pH13

## Main characteristics:

- External and internal coating: red epoxy powder 250µm (PECR)
- EN 598 / CE Marking
- Declaration of performances [DoP-INTEGRAL005EN](#)
- Designed according to the regulatory texts:
  - NF EN 476: general prescriptions for components used in the networks
  - NF EN 752: Conception of sewage projects
  - NF EN 1610: Reception of the works
  - CCTG: Fascicule 70 (sewage work)

## Linked products

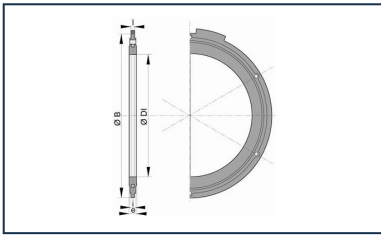

Flanged joint with hot galvanized steel bolts, nuts and washers for sewage

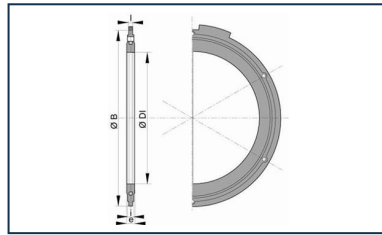

Flanged joint with hot galvanized steel bolts, nuts and washers

*The information on this sketch is, to the best of our knowledge correct at the time of printing. However Saint-Gobain are constantly looking at ways of improving their products and services therefore reserve the right to change without prior notice, any of the data shown. Any orders placed will be subject to our Standard Conditions of Sale, available on request.*