

Tee (PECB) with 2 sockets STANDARD and Rotatable Flange branch

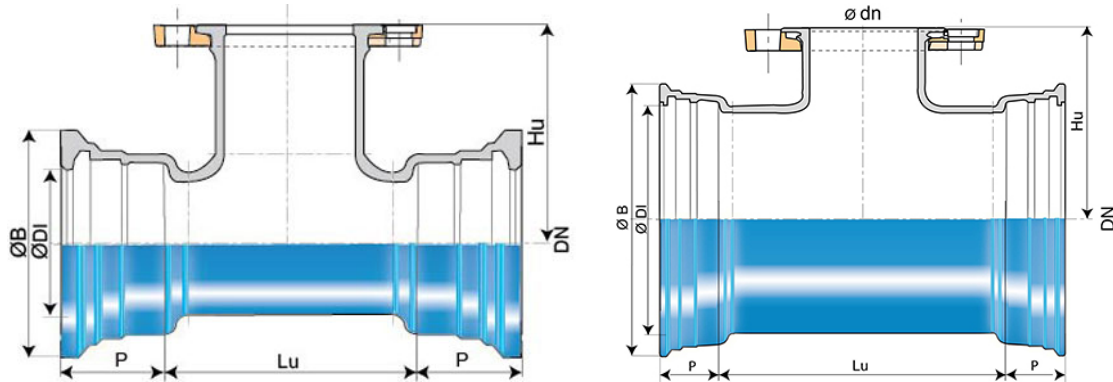

| DN (mm) | Ødn (mm) | Lu (mm) | Hu (mm) | P (mm) | ØDI (mm) | ØB (mm) | PN 10 | | PN 16 | | PN 25 | |
|---------|----------|---------|---------|--------|----------|---------|-----------|-------------|-----------|-------------|-----------|-------------|
| | | | | | | | Mass (kg) | References | Mass (kg) | References | Mass (kg) | References |
| 60 | 60 | 154 | 161 | 82 | 80.2 | 143.5 | 9.70 | SSA60UD1CTT | 9.70 | SSA60UD1CTT | | |
| 80 | 40 | 145 | 149 | 85 | 101.4 | 167.5 | 10.20 | SSA80UD1ATT | 10.20 | SSA80UD1ATT | 10.20 | SSA80UD1ATT |
| 80 | 60 | 145 | 169 | 85 | 101.4 | 167.5 | 11.10 | SSA80UD1CTT | 11.10 | SSA80UD1CTT | | |
| 80 | 80 | 183 | 165 | 85 | 101.4 | 167.5 | 12.50 | SSA80UD1ETT | 12.50 | SSA80UD1ETT | 12.50 | SSA80UD1ETT |
| 100 | 40 | 150 | 161 | 88 | 121.4 | 187.5 | 12.00 | SSB10UD1ATT | 12.00 | SSB10UD1ATT | 12.00 | SSB10UD1ATT |
| 100 | 60 | 150 | 181 | 88 | 121.4 | 187.5 | 12.90 | SSB10UD1CTT | 12.90 | SSB10UD1CTT | | |
| 100 | 80 | 185 | 177 | 88 | 121.4 | 187.5 | 14.60 | SSB10UD1ETT | 14.60 | SSB10UD1ETT | 14.60 | SSB10UD1ETT |
| 100 | 100 | 210 | 180 | 88 | 121.4 | 187.5 | 16.40 | SSB10UD1FTT | 16.40 | SSB10UD1FTT | | |
| 125 | 60 | 150 | 184 | 91 | 147.4 | 214.5 | 15.20 | SSB12UD1CTT | 15.20 | SSB12UD1CTT | | |
| 125 | 80 | 165 | 195 | 91 | 147.4 | 214.5 | 16.80 | SSB12UD1ETT | 16.80 | SSB12UD1ETT | 16.80 | SSB12UD1ETT |
| 125 | 100 | 190 | 200 | 91 | 147.4 | 214.5 | 18.50 | SSB12UD1FTT | 18.50 | SSB12UD1FTT | | |
| 125 | 125 | 267 | 200 | 91 | 147.4 | 214.5 | 23.00 | SSB12UD1GTT | 23.00 | SSB12UD1GTT | | |
| 150 | 40 | 154 | 176 | 94 | 173.4 | 241 | 17.10 | SSB15UD1ATT | 17.10 | SSB15UD1ATT | 17.10 | SSB15UD1ATT |
| 150 | 60 | 154 | 196 | 94 | 173.4 | 241 | 18.00 | SSB15UD1CTT | 18.00 | SSB15UD1CTT | | |
| 150 | 80 | 165 | 210 | 94 | 173.4 | 241 | 19.60 | SSB15UD1ETT | 19.60 | SSB15UD1ETT | 19.60 | SSB15UD1ETT |
| 150 | 100 | 190 | 215 | 94 | 173.4 | 241 | 21.40 | SSB15UD1FTT | 21.40 | SSB15UD1FTT | | |
| 150 | 150 | 305 | 220 | 94 | 173.4 | 241 | 29.50 | SSB15UD1JTT | 29.50 | SSB15UD1JTT | | |
| 200 | 60 | 159 | 229.5 | 100 | 225.5 | 294 | 26.00 | SSB20UD1CTT | 26.00 | SSB20UD1CTT | | |
| 200 | 80 | 170 | 240 | 100 | 225.5 | 294 | 27.00 | SSB20UD1ETT | 27.00 | SSB20UD1ETT | 27.00 | SSB20UD1ETT |
| 200 | 100 | 195 | 245 | 100 | 225.5 | 294 | 29.10 | SSB20UD1FTT | 29.10 | SSB20UD1FTT | 29.60 | SSB20UD3FTT |
| 200 | 150 | 250 | 245 | 100 | 225.5 | 294 | 34.90 | SSB20UD1JTT | 34.90 | SSB20UD1JTT | | |

| | | | | | | | PN 10 | | PN 16 | | PN 25 | |
|---------|----------|---------|---------|--------|----------|---------|-----------|--------------|-----------|--------------|-----------|--------------|
| DN (mm) | Ødn (mm) | Lu (mm) | Hu (mm) | P (mm) | ØDI (mm) | ØB (mm) | Mass (kg) | References | Mass (kg) | References | Mass (kg) | References |
| 200 | 200 | 360 | 260 | 100 | 225.5 | 294 | 44.70 | SSB20UD1KTT | 44.60 | SSB20UD2KTT | | |
| 250 | 60 | 165 | 260 | 105 | 277.8 | 351 | 31.40 | SSB25UD1CTT2 | 31.40 | SSB25UD1CTT2 | | |
| 250 | 80 | 155 | 265 | 105 | 277.8 | 351 | 31.30 | SSB25UD1ETT2 | 31.30 | SSB25UD1ETT2 | 31.30 | SSB25UD1ETT2 |
| 250 | 150 | 235 | 255 | 105 | 277.8 | 351 | 39.00 | SSB25UD1JTT2 | 39.00 | SSB25UD1JTT2 | | |
| 250 | 200 | 290 | 265 | 105 | 277.8 | 351 | 47.00 | SSB25UD1KTT2 | 47.20 | SSB25UD2KTT2 | | |
| 250 | 250 | 350 | 275 | 105 | 277.8 | 351 | 55.80 | SSB25UD1LTT2 | 55.80 | SSB25UD2LTT2 | | |
| 300 | 60 | 165 | 290 | 110 | 329.8 | 408.3 | 41.70 | SSB30UD1CTT2 | 41.70 | SSB30UD1CTT2 | | |
| 300 | 80 | 155 | 295 | 110 | 329.8 | 408.3 | 41.50 | SSB30UD1ETT2 | 41.50 | SSB30UD1ETT2 | 41.50 | SSB30UD1ETT2 |
| 300 | 100 | 180 | 275 | 110 | 329.8 | 408.3 | 41.80 | SSB30UV1FTT2 | 41.80 | SSB30UV1FTT2 | | |
| 300 | 150 | 235 | 285 | 110 | 329.8 | 408.3 | 48.80 | SSB30UD1JTT2 | 48.80 | SSB30UD1JTT2 | | |
| 300 | 200 | 295 | 295 | 110 | 329.8 | 408.3 | 58.30 | SSB30UD1KTT2 | 58.50 | SSB30UD2KTT2 | | |
| 300 | 250 | 380 | 330 | 110 | 329.8 | 408.3 | | | 67.90 | SSB30UD2LTT2 | | |
| 300 | 300 | 410 | 315 | 110 | 329.8 | 408.3 | 79.10 | SSB30UD1MTT2 | 78.60 | SSB30UD2MTT2 | | |
| 350 | 60 | 170 | 320 | 110 | 381.9 | 464.3 | 48.41 | SSB35UD1CTT2 | 48.41 | SSB35UD1CTT2 | 48.41 | SSB35UD3CTT2 |
| 350 | 80 | 185 | 325 | 110 | 381.9 | 464.3 | 50.09 | SSB35UD1ETT2 | 50.09 | SSB35UD1ETT2 | 50.09 | SSB35UD1ETT2 |
| 350 | 150 | 270 | 340 | 110 | 381.9 | 464.3 | 59.85 | SSB35UD1JTT2 | 59.85 | SSB35UD1JTT2 | 61.95 | SSB35UD3JTT2 |
| 350 | 200 | 300 | 325 | 110 | 381.9 | 464.3 | 66.50 | SSB35UD1KTT2 | 66.70 | SSB35UD2KTT2 | 68.00 | SSB35UD3KTT2 |
| 350 | 250 | 385 | 360 | 110 | 381.9 | 464.3 | 78.50 | SSB35UD1LTT2 | 78.50 | SSB35UD2LTT2 | | |
| 350 | 300 | 410 | 345 | 110 | 381.9 | 464.3 | 84.80 | SSB35UD1MTT2 | 84.30 | SSB35UD2MTT2 | | |
| 350 | 350 | 485 | 380 | 110 | 381.4 | 464.3 | 131.00 | SSB35UD1YTT | 132.00 | SSB35UD2YTT | | |
| 400 | 80 | 175 | 330 | 112 | 432.9 | 515.3 | 61.00 | SSB40UD1ETT2 | 61.00 | SSB40UD1ETT2 | 61.00 | SSB40UD1ETT2 |
| 400 | 150 | 245 | 345 | 112 | 432.9 | 515.3 | 68.46 | SSB40UD1JTT2 | 68.46 | SSB40UD1JTT2 | | |
| 400 | 200 | 300 | 355 | 112 | 432.9 | 515.3 | 77.39 | SSB40UD1KTT2 | 77.60 | SSB40UD2KTT2 | | |
| 400 | 250 | 385 | 390 | 112 | 432.9 | 515.3 | 90.72 | SSB40UD1LTT2 | 90.72 | SSB40UD2LTT2 | 93.45 | SSB40UD3LTT2 |
| 400 | 300 | 415 | 375 | 112 | 432.9 | 515.3 | 97.55 | SSB40UD1MTT2 | 97.02 | SSB40UD2MTT2 | | |
| 400 | 400 | 535 | 395 | 110 | 432.9 | 515.3 | 121.59 | SSB40UD1NTT2 | 126.32 | SSB40UD2NTT2 | 135.77 | SSB40UD3NTT2 |
| 450 | 150 | 270 | 400 | 115.5 | 484 | 573 | 86.63 | SSB45UD1JTT2 | 86.63 | SSB45UD1JTT2 | 88.73 | SSB45UD3JTT2 |
| 450 | 450 | 600 | 460 | 115.5 | 483.5 | 573 | 201.00 | SSB45UD1PTT | 207.00 | SSB45UD2PTT | | |
| 500 | 150 | 325 | 430 | 117.5 | 535.5 | 628 | 132.20 | SSB50UD1JTT | 132.20 | SSB50UD1JTT | 134.20 | SSB50UD3JTT |
| 500 | 200 | 305 | 415 | 117.5 | 536 | 628 | 108.80 | SSB50UD1KTT2 | 109.00 | SSB50UD2KTT2 | 110.40 | SSB50UD3KTT2 |
| 500 | 250 | 443 | 450 | 117.5 | 535.5 | 628 | 149.60 | SSB50UD1LTT | | | | |
| 500 | 300 | 443 | 460 | 117.5 | 535.5 | 628 | 188.00 | SSB50UD1MTT | 188.00 | SSB50UD2MTT | | |
| 500 | 400 | 540 | 455 | 117.5 | 536 | 628 | 159.10 | SSB50UD1NTT2 | 163.80 | SSB50UD2NTT2 | | |

| | | | | | | | PN 10 | | PN 16 | | PN 25 | |
|---------|----------|---------|---------|--------|----------|---------|-----------|--------------|-----------|--------------|-----------|-------------|
| DN (mm) | Ødn (mm) | Lu (mm) | Hu (mm) | P (mm) | ØDI (mm) | ØB (mm) | Mass (kg) | References | Mass (kg) | References | Mass (kg) | References |
| 500 | 500 | 655 | 475 | 117.5 | 536 | 628 | 256.31 | SSB50UD1QTT2 | 269.96 | SSB50UD2QTT2 | | |
| 600 | 150 | 340 | 490 | 132.5 | 638.6 | 737 | 168.00 | SSB60UD1JTT | 168.00 | SSB60UD1JTT | | |
| 600 | 300 | 452 | 520 | 132.5 | 638.6 | 737 | 230.30 | SSB60UD1MTT | 229.60 | SSB60UD2MTT | | |
| 600 | 400 | 545 | 515 | 132.5 | 639.1 | 737 | 208.00 | SSB60UD1NTT2 | 213.00 | SSB60UD2NTT2 | | |
| 600 | 600 | 800 | 580 | 132.5 | 638.6 | 737 | 373.00 | SSB60UD1RRT | 398.00 | SSB60UD2RRT | | |
| 700 | 150 | 365 | 520 | 150 | 742.2 | 861 | 262.20 | SSB70UD1JTT | 262.20 | SSB70UD1JTT | 263.00 | SSB70UD3JTT |
| 700 | 200 | 365 | 525 | 150 | 742.2 | 861 | 265.00 | SSB70UD1KTT | 265.00 | SSB70UD2KTT | | |
| 700 | 400 | 585 | 555 | 150 | 742.2 | 861 | 347.00 | SSB70UD1NTT | 351.00 | SSB70UD2NTT | | |
| 700 | 600 | 915 | 585 | 150 | 742.2 | 861 | 474.00 | SSB70UD1RRT | 499.00 | SSB70UD2RRT | 502.00 | SSB70UD3RRT |
| 800 | 150 | 355 | 580 | 160 | 846.3 | 972 | 332.00 | SSB80UD1JTT | 332.00 | SSB80UD1JTT | 333.00 | SSB80UD3JTT |
| 800 | 200 | 355 | 585 | 160 | 846.3 | 972 | 335.00 | SSB80UD1KTT | 336.00 | SSB80UD2KTT | | |
| 800 | 400 | 575 | 615 | 160 | 846.3 | 972 | 430.00 | SSB80UD1NTT | 435.00 | SSB80UD2NTT | | |
| 800 | 600 | 1015 | 645 | 160 | 846.3 | 972 | 617.00 | SSB80UD1RRT | 642.00 | SSB80UD2RRT | 645.00 | SSB80UD3RRT |
| 900 | 200 | 375 | 645 | 175 | 949.4 | 1080 | 420.00 | SSB90UD1KTT | 419.00 | SSB90UD2KTT | | |
| 900 | 400 | 595 | 675 | 175 | 949.4 | 1080 | 532.00 | SSB90UD1NTT | 536.00 | SSB90UD2NTT | 545.00 | SSB90UD3NTT |
| 900 | 600 | 1145 | 705 | 175 | 949.4 | 1080 | 798.00 | SSB90UD1RRT | 823.00 | SSB90UD2RRT | 826.00 | SSB90UD3RRT |
| 1000 | 150 | 379 | 705 | 185 | 1052.5 | 1189 | 447.00 | SSC10UD1JTT | 447.00 | SSC10UD1JTT | | |
| 1000 | 200 | 379 | 705 | 185 | 1052.5 | 1189 | 510.00 | SSC10UD1KTT | 510.00 | SSC10UD2KTT | 512.00 | SSC10UD3KTT |
| 1000 | 400 | 598.5 | 735 | 185 | 1052.5 | 1189 | 639.00 | SSC10UD1NTT | 644.00 | SSC10UD2NTT | 653.00 | SSC10UD3NTT |
| 1000 | 600 | 1258.5 | 765 | 185 | 1052.5 | 1189 | 1007.00 | SSC10UD1RRT | 1032.00 | SSC10UD2RRT | 1035.00 | SSC10UD3RRT |
| 1000 | 300 | 598.5 | 720 | 185 | 1052.5 | 1189 | | | 569.00 | SSC10UD2MTT | 574.00 | SSC10UD3MTT |
| 1100 | 200 | 822.5 | 880 | 150 | 1152 | 1298 | | | 910.90 | SSC11UD2KTT | | |
| 1100 | 400 | 822.5 | 835 | 150 | 1152 | 1298 | | | 1003.00 | SSC11UD2NTT | | |
| 1100 | 600 | 822.5 | 885 | 150 | 1152 | 1298 | 907.00 | SSC11UD1RRT | 932.00 | SSC11UD2RRT | | |
| 1200 | 200 | 855 | 880 | 195 | 1263 | 1412 | 949.00 | SSC12UD1KTT | 949.00 | SSC12UD2KTT | | |
| 1200 | 300 | 855 | 838 | 195 | 1263 | 1412 | 927.00 | SSC12UD1MTT | | | | |
| 1200 | 400 | 855 | 835 | 195 | 1263 | 1412 | 938.00 | SSC12UD1NTT | | | | |
| 1200 | 600 | 855 | 885 | 195 | 1263 | 1412 | 953.00 | SSC12UD1RRT | | | | |
| 1400 | 600 | 1010 | 980 | 255 | 1467 | 1600 | 1542.00 | SSC14UD1RRT | 1567.00 | SSC14UD2RRT | 1567.75 | SSC14UD3RRT |
| 1400 | 250 | 1010 | 1000 | 255 | 1467 | 1600 | | | 1511.00 | SSC14UD2LTT | | |
| 1600 | 300 | 1050 | 1050 | 275 | 1673 | 1820 | | | 1967.00 | SSC16UD2MTT | 1979.00 | SSC16UD3MTT |
| 1800 | 600 | 1125 | 1200 | 258 | 1881.7 | 2038 | | | | | 2388.00 | SSC18UD3RRT |
| 2000 | 300 | 1110 | 1265 | 290 | 2089 | 2269 | | | 3201.00 | SSC20UD2MTT | | |

Field of use:

- For drinking water and irrigation networks
- For aggressive soils (maritime soils, peaty, ...)

Main characteristics:

- External and internal coating : Blue epoxy powder 250 microns average thickness with a minimum of 200 microns, conforming to EN 14901-1 (PECB)
- In conformity with EN 545:2010 and ISO 2531:2009

Linked products

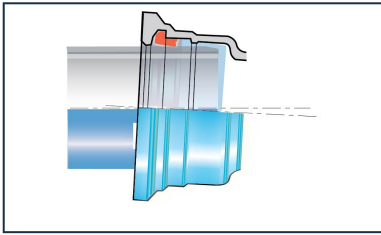

Kit Standard Double
Socket Tee with flanged
branch PECB + Standard
Gasket

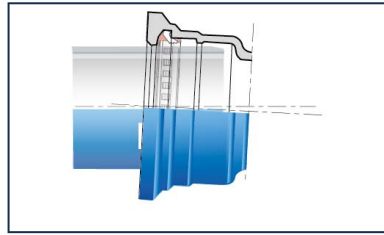

Kit Standard Fitting PECB
+ Standard Vi Gasket

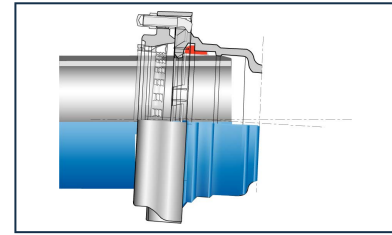

Kit Standard Fitting PECB
+ Standard V+i Joint

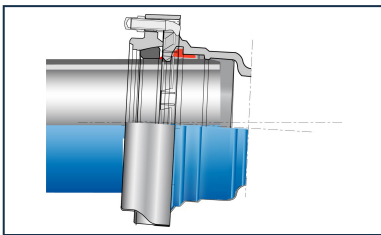

Kit Standard Fitting PECB
+ Standard Ve Joint

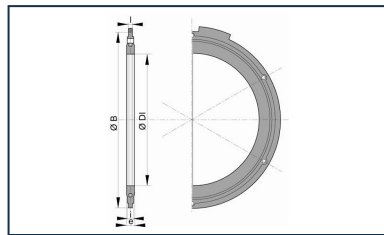

Flanged joint with
metallized steel bolts and
nuts

The information on this sketch is, to the best of our knowledge correct at the time of printing. However Saint-Gobain are constantly looking at ways of improving their products and services therefore reserve the right to change without prior notice, any of the data shown. Any orders placed will be subject to our Standard Conditions of Sale, available on request.