

Tee (PECB) with 2 sockets UNIVERSAL STANDARD and Rotatable Flange branch

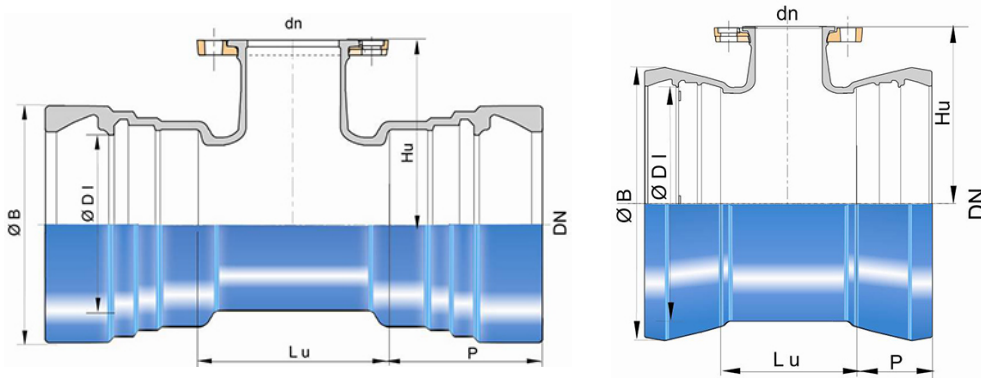

DN	PN	Ødn (mm)	Lu (mm)	Hu (mm)	P (mm)	ØDI (mm)	ØB (mm)	Mass (kg)	References
100	10 16 25 40	80	170	175	142	121.4	177	21.20	SFB10UD1ETT
100	10 16	100	190	180	142	121.4	177	22.50	SFB10UD1FTT
100	25 40	100	190	180	142	121.4	177	23.00	SFB10UD3FTT
125	10 16	100	195	195	148	147.4	201.4	21.50	SFB12UD1FTT
150	10 16	100	195	210	150	173.4	230	31.40	SFB15UD1FTT
150	10 16	150	255	220	150	173.4	230	36.40	SFB15UD1JTT
200	10 16 25 40	80	175	235	158	225.5	290	42.90	SFB20UD1ETT
200	10 16	100	200	240	158	225.5	290	45.00	SFB20UD1FTT
200	16	200	315	260	158	225.5	290	57.00	SFB20UD2KTT
200	25 40	100	200	240	158	225.5	290	45.50	SFB20UD3FTT
250	10 16 25 40	80	180	265	166	276.8	347	56.60	SFB25UD1ETT
250	10	250	375	300	166	276.8	347	80.60	SFB25UD1LTT
250	16	200	315	290	166	276.8	347	72.30	SFB25UD2KTT
250	16	250	375	300	166	276.8	347	80.20	SFB25UD2LTT
250	25 40	100	200	270	166	276.8	347	59.24	SFB25UD3FTT
250	40	200	315	290	166	276.8	347	74.20	SFB25UD4KTT
300	10 16 25 40	80	180	295	178	328.8	406	69.50	SFB30UD1ETT
300	10 16	100	205	300	178	328.8	406	79.90	SFB30UD1FTT
300	10 16	150	260	310	178	328.8	406	86.30	SFB30UD1JTT
300	10	200	320	320	178	328.8	406	95.50	SFB30UD1KTT
300	16	200	320	320	178	328.8	406	88.00	SFB30UD2KTT

DN	PN	Ødn (mm)	Lu (mm)	Hu (mm)	P (mm)	ØDI (mm)	ØB (mm)	Mass (kg)	References
300	16	250	435	330	178	328.8	406	108.50	SFB30UD2LTT
300	16	300	435	340	178	328.8	406	109.00	SFB30UD2MTT
300	25 40	100	205	300	178	328.8	406	80.40	SFB30UD3FTT
300	40	200	320	320	178	328.8	406	97.30	SFB30UD4KTT
300	40	250	435	330	178	328.8	406	118.20	SFB30UD4LTT
400	10 16 25	80	185	355	176	432	512	85.40	SFB40UD1ETT
400	10 16	100	210	360	176	432	512	88.00	SFB40UD1FTT
400	10 16	150	270	370	176	432	512	103.16	SFB40UD1JTT
400	10	300	440	400	176	432	512	138.30	SFB40UD1MTT
400	10	400	560	420	176	432	512	174.68	SFB40UD1NTT
400	16	200	325	380	176	432	512	118.00	SFB40UD2KTT
400	16	300	440	400	176	432	512	138.10	SFB40UD2MTT
400	16	400	560	420	176	432	512	178.80	SFB40UD2NTT
400	25	100	210	360	176	432	512	89.00	SFB40UD3FTT
400	25	150	270	370	176	432	512	105.20	SFB40UD3JTT
400	25	200	325	380	176	432	512	119.00	SFB40UD3KTT
400	25	300	440	400	176	432	512	141.70	SFB40UD3MTT
500	10 16 25	80	215	415	200	535	626	149.70	SFB50UD1ETT
500	10 16	100	215	420	200	535	626	147.00	SFB50UD1FTT
500	10 16	150	330	430	200	535	626	166.00	SFB50UD1JTT
500	10	200	330	440	200	535	626	180.00	SFB50UD1KTT
500	10	300	450	470	200	535	626	197.30	SFB50UD1MTT
500	10	500	680	500	200	535	626	350.00	SFB50UD1QTT
500	16	200	330	440	200	535	626	179.90	SFB50UD2KTT
500	16	250	450	450	200	535	626	197.20	SFB50UD2LTT
500	16	300	450	470	200	535	626	196.60	SFB50UD2MTT
500	16	400	565	480	200	535	626	231.80	SFB50UD2NTT
500	16	500	680	500	200	535	626	363.00	SFB50UD2QTT
500	25	100	215	420	200	535	626	148.00	SFB50UD3FTT
500	25	150	330	430	200	535	626	167.10	SFB50UD3JTT
500	25	500	680	500	200	535	626	369.00	SFB50UD3QTT
600	10 16	100	340	480	209	638	742	227.80	SFB60UD1FTT
600	10 16	150	340	490	209	638	742	229.16	SFB60UD1JTT
600	10	200	340	500	209	638	742	237.00	SFB60UD1KTT
600	10	300	570	520	209	638	742	295.00	SFB60UD1MTT

DN	PN	Ødn (mm)	Lu (mm)	Hu (mm)	P (mm)	ØDI (mm)	ØB (mm)	Mass (kg)	References
600	10	600	800	580	209	638	742	385.00	SFB60UD1RTT
600	16	200	340	500	209	638	742	237.00	SFB60UD2KTT
600	16	250	570	510	209	638	742	284.20	SFB60UD2LTT
600	16	300	570	520	209	638	742	295.00	SFB60UD2MTT
600	16	400	570	540	209	638	742	306.80	SFB60UD2NTT
600	16	600	800	580	209	638	742	410.00	SFB60UD2RTT
600	25	100	340	480	209	638	742	229.00	SFB60UD3FTT
600	25	150	340	490	209	638	742	231.20	SFB60UD3JTT
700	10 16	150	365	520	256	740.5	857	403.00	SFB70UD1JTT
700	10	200	365	525	256	740.5	857	427.90	SFB70UD1KTT
700	10	300	585	530	256	740.5	857	511.00	SFB70UD1MTT
700	10	400	585	555	256	740.5	857	566.00	SFB70UD1NTT
700	16	200	365	525	256	740.5	857	428.10	SFB70UD2KTT
700	16	300	585	530	256	740.5	857	510.00	SFB70UD2MTT
700	16	400	585	555	256	740.5	857	570.00	SFB70UD2NTT
700	25	150	365	520	256	740.5	857	405.00	SFB70UD3JTT
700	25	200	365	525	256	740.5	857	429.38	SFB70UD3KTT
700	25	300	585	530	256	740.5	857	512.00	SFB70UD3MTT
700	25	400	585	555	256	740.5	857	579.00	SFB70UD3NTT
800	10	200	355	585	261	845.8	983.8	530.00	SFB80UD1KTT
800	10	400	580	615	261	845.8	983.8	657.00	SFB80UD1NTT
800	10	600	1015	645.8	261	845.8	983.8	820.00	SFB80UD1RTT
800	16	200	355	585	261	845.8	983.8	530.00	SFB80UD2KTT
800	16	600	1015	645.8	261	845.8	983.8	878.00	SFB80UD2RTT
800	25	200	355	585	261	845.8	983.8	531.00	SFB80UD3KTT
800	25	600	1015	645.8	261	845.8	983.8	848.00	SFB80UD3RTT
900	10	600	1145	705	275	948.9	1093	1180.00	SFB90UD1RTT
900	16	600	1145	705	275	948.9	1093	1205.00	SFB90UD2RTT
900	25	600	1145	705	275	948.9	1093	1208.00	SFB90UD3RTT
1000	10	600	1265	765	272.5	1052	1216	1422.00	SFC10UD1RTT
1000	16	600	1265	765	272.5	1052	1216	1404.00	SFC10UD2RTT
1000	25	600	1265	765	272.5	1052	1216	1407.00	SFC10UD3RTT
1200	10	200	822.5	880	279.5	1260	1419.6	1421.00	SFC12UD1KTT
1200	10	300	822.5	838	279.5	1260	1419.6	1428.00	SFC12UD1MTT
1200	10	400	822.5	835	279.5	1260	1419.6	1453.00	SFC12UD1NTT

DN	PN	Ødn (mm)	Lu (mm)	Hu (mm)	P (mm)	ØDI (mm)	ØB (mm)	Mass (kg)	References
1200	10	600	840	885	279.5	1260	1419.6	1485.00	SFC12UD1RTT
1200	16	200	822.5	880	279.5	1260	1419.6	1421.00	SFC12UD2KTT
1200	16	300	822.5	838	279.5	1260	1419.6	1428.00	SFC12UD2MTT
1200	16	400	822.5	835	279.5	1260	1419.6	1457.00	SFC12UD2NTT
1200	16	600	840	885	279.5	1260	1419.6	1510.00	SFC12UD2RTT
1200	25	200	822.5	880	279.5	1260	1419.6	1422.00	SFC12UD3KTT
1200	25	300	822.5	838	279.5	1260	1419.6	1431.00	SFC12UD3MTT
1200	25	400	822.5	835	279.5	1260	1419.6	1466.00	SFC12UD3NTT
1200	25	600	840	885	279.5	1260	1419.6	1513.00	SFC12UD3RTT
1200	10	250	822.5	873	279.5	1260	1419.6	1423.00	SFC12UV1LTT
1200	16	250	822.5	873	279.5	1260	1419.6	1423.00	SFC12UV2LTT
1200	25	250	822.5	873	279.5	1260	1419.6	1426.00	SFC12UV3LTT
1400	10	600	1010	980	330	1468.5	1650.1	2106.00	SFC14UD1RTT

Field of use:

- To use under high to very high pressures

Main characteristics:

- External and internal coating : Blue epoxy powder 250 microns average thickness with a minimum of 200 microns, conforming to EN 14901-1 (PECB)
- In conformity with EN 545:2010 and ISO 2531:2009

Linked products

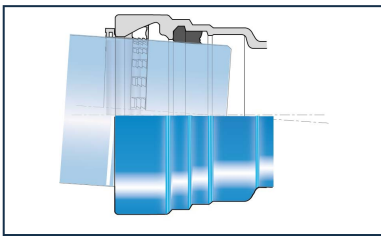

Kit Universal Standard Fitting PECB + Universal Standard Vi Joint

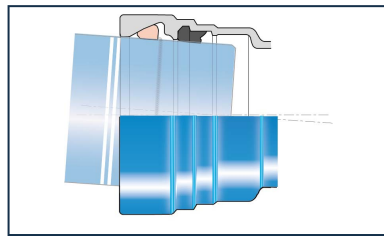

Kit Universal Standard Fitting PECB + Universal Standard Ve Joint

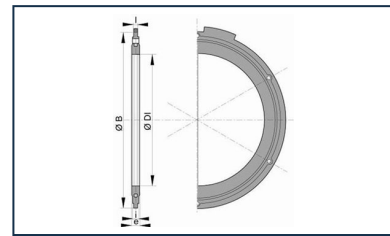

Flanged joint with hot galvanized steel bolts, nuts and washers

The information on this sketch is, to the best of our knowledge correct at the time of printing. However Saint-Gobain are constantly looking at ways of improving their products and services therefore reserve the right to change without prior notice, any of the data shown. Any orders placed will be subject to our Standard Conditions of Sale, available on request.