

Tyton Vi gasket for Tyton Pipes and Fittings

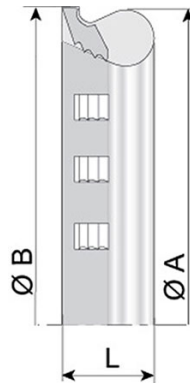

The anchored TYTON Vi gasket (with inserts) has the same shape than the TYTON gasket, and fits the same socket. The TYTON Vi gasket has inserts which anchor the socket joint by hooking into the pipe spigot (or the fitting) after the assembling.

DN (mm)	L (mm)	ØA (mm)	ØB (mm)	Mass (kg)	References
80	26	124	126	0.17	172927
100	26	144	146	0.19	172929
125	26	171	173	0.23	172930
150	26	198	200	0.27	172931
200	30	254	256	0.45	172933
250	32	208	310	0.60	172964
300	36	364	366	0.92	172967

Field of use:

- For drinking water networks

Main characteristics:

- Elastomer quality : EPDM
- Quick and easy installation
- Possible axial play
- High coefficient security beyond the PFA
- High angular deflection possible

The information on this sketch is, to the best of our knowledge correct at the time of printing. However Saint-Gobain are constantly looking at ways of improving their products and services therefore reserve the right to change without prior notice, any of the data shown. Any orders placed will be subject to our Standard Conditions of Sale, available on request.