

## Welded Flange Spigot pipe with Anchor flange (central puddle flange)

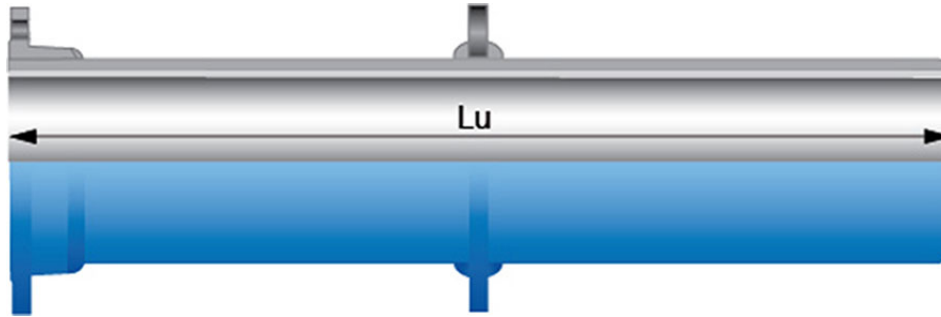

| DN  | Lu (mm) | PN 10     |             | PN 16     |             |
|-----|---------|-----------|-------------|-----------|-------------|
|     |         | Mass (kg) | References  | Mass (kg) | References  |
| 60  | 500     | 11.00     | BBA60FE1BAQ | 11.00     | BBA60FE1BAQ |
| 60  | 1000    | 15.00     | BBA60FE1CAQ | 15.00     | BBA60FE1CAQ |
| 60  | 2000    | 26.00     | BBA60FE1EAQ | 26.00     | BBA60FE1EAQ |
| 60  | 3000    | 38.00     | BBA60FE1GAQ | 38.00     | BBA60FE1GAQ |
| 60  | 4000    | 49.00     | BBA60FE1JAQ | 49.00     | BBA60FE1JAQ |
| 60  | 5000    | 60.00     | BBA60FE1LAQ | 60.00     | BBA60FE1LAQ |
| 80  | 500     | 15.00     | BBA80FE1BAQ | 15.00     | BBA80FE1BAQ |
| 80  | 1000    | 23.00     | BBA80FE1CAQ | 23.00     | BBA80FE1CAQ |
| 80  | 2000    | 38.00     | BBA80FE1EAQ | 38.00     | BBA80FE1EAQ |
| 80  | 3000    | 53.00     | BBA80FE1GAQ | 53.00     | BBA80FE1GAQ |
| 80  | 4000    | 67.00     | BBA80FE1JAQ | 67.00     | BBA80FE1JAQ |
| 80  | 5000    | 82.00     | BBA80FE1LAQ | 82.00     | BBA80FE1LAQ |
| 100 | 500     | 18.00     | BBB10FE1BAQ | 18.00     | BBB10FE1BAQ |
| 100 | 1000    | 27.00     | BBB10FE1CAQ | 27.00     | BBB10FE1CAQ |
| 100 | 2000    | 45.00     | BBB10FE1EAQ | 45.00     | BBB10FE1EAQ |
| 100 | 3000    | 63.00     | BBB10FE1GAQ | 63.00     | BBB10FE1GAQ |
| 100 | 4000    | 81.00     | BBB10FE1JAQ | 81.00     | BBB10FE1JAQ |
| 100 | 5000    | 99.00     | BBB10FE1LAQ | 99.00     | BBB10FE1LAQ |
| 125 | 500     | 22.00     | BBB12FE1BAQ | 22.00     | BBB12FE1BAQ |
| 125 | 1000    | 30.00     | BBB12FE1CAQ | 30.00     | BBB12FE1CAQ |
| 125 | 2000    | 52.00     | BBB12FE1EAQ | 52.00     | BBB12FE1EAQ |
| 125 | 3000    | 75.00     | BBB12FE1GAQ | 75.00     | BBB12FE1GAQ |

|     |         | PN 10     |             | PN 16     |             |
|-----|---------|-----------|-------------|-----------|-------------|
| DN  | Lu (mm) | Mass (kg) | References  | Mass (kg) | References  |
| 125 | 4000    | 97.00     | BBB12FE1JAQ | 97.00     | BBB12FE1JAQ |
| 125 | 5000    | 119.00    | BBB12FE1LAQ | 119.00    | BBB12FE1LAQ |
| 150 | 500     | 27.00     | BBB15FE1BAQ | 27.00     | BBB15FE1BAQ |
| 150 | 1000    | 40.00     | BBB15FE1CAQ | 40.00     | BBB15FE1CAQ |
| 150 | 2000    | 67.00     | BBB15FE1EAQ | 67.00     | BBB15FE1EAQ |
| 150 | 3000    | 94.00     | BBB15FE1GAQ | 94.00     | BBB15FE1GAQ |
| 150 | 4000    | 121.00    | BBB15FE1JAQ | 121.00    | BBB15FE1JAQ |
| 150 | 5000    | 148.00    | BBB15FE1LAQ | 148.00    | BBB15FE1LAQ |
| 200 | 500     | 42.00     | BBB20FE1BAQ | 37.00     | BBB20FE2BAQ |
| 200 | 1000    | 60.00     | BBB20FE1CAQ | 55.00     | BBB20FE2CAQ |
| 200 | 2000    | 97.00     | BBB20FE1EAQ | 93.00     | BBB20FE2EAQ |
| 200 | 3000    | 134.00    | BBB20FE1GAQ | 130.00    | BBB20FE2GAQ |
| 200 | 4000    | 172.00    | BBB20FE1JAQ | 167.00    | BBB20FE2JAQ |
| 200 | 5000    | 209.00    | BBB20FE1LAQ | 204.00    | BBB20FE2LAQ |
| 250 | 500     | 47.00     | BBB25FE1BAQ | 48.00     | BBB25FE2BAQ |
| 250 | 1000    | 70.00     | BBB25FE1CAQ | 70.00     | BBB25FE2CAQ |
| 250 | 2000    | 116.00    | BBB25FE1EAQ | 116.00    | BBB25FE2EAQ |
| 250 | 3000    | 161.00    | BBB25FE1GAQ | 161.00    | BBB25FE2GAQ |
| 250 | 4000    | 207.00    | BBB25FE1JAQ | 207.00    | BBB25FE2JAQ |
| 250 | 5000    | 116.00    | BBB25FE1LAQ | 252.00    | BBB25FE2LAQ |
| 300 | 500     | 68.00     | BBB30FE1BAQ | 69.00     | BBB30FE2BAQ |
| 300 | 1000    | 95.00     | BBB30FE1CAQ | 95.00     | BBB30FE2CAQ |
| 300 | 2000    | 148.00    | BBB30FE1EAQ | 146.90    | BBB30FE2EAQ |
| 300 | 3000    | 201.00    | BBB30FE1GAQ | 202.00    | BBB30FE2GAQ |
| 300 | 4000    | 254.00    | BBB30FE1JAQ | 255.00    | BBB30FE2JAQ |
| 300 | 5000    | 307.00    | BBB30FE1LAQ | 308.00    | BBB30FE2LAQ |
| 350 | 500     | 94.00     | BBB35FE1BAQ | 87.00     | BBB35FE2BAQ |
| 350 | 1000    | 127.00    | BBB35FE1CAQ | 120.00    | BBB35FE2CAQ |
| 350 | 2000    | 193.00    | BBB35FE1EAQ | 186.00    | BBB35FE2EAQ |
| 350 | 3000    | 259.00    | BBB35FE1GAQ | 252.00    | BBB35FE2GAQ |
| 350 | 4000    | 325.00    | BBB35FE1JAQ | 318.00    | BBB35FE2JAQ |
| 350 | 5000    | 391.00    | BBB35FE1LAQ | 384.00    | BBB35FE2LAQ |
| 400 | 500     | 99.00     | BBB40FE1BAQ | 104.00    | BBB40FE2BAQ |

|     |         | PN 10     |             | PN 16     |             |
|-----|---------|-----------|-------------|-----------|-------------|
| DN  | Lu (mm) | Mass (kg) | References  | Mass (kg) | References  |
| 400 | 1000    | 137.00    | BBB40FE1CAQ | 142.00    | BBB40FE2CAQ |
| 400 | 2000    | 213.00    | BBB40FE1EAQ | 218.00    | BBB40FE2EAQ |
| 400 | 3000    | 289.00    | BBB40FE1GAQ | 294.00    | BBB40FE2GAQ |
| 400 | 4000    | 365.00    | BBB40FE1JAQ | 370.00    | BBB40FE2JAQ |
| 400 | 5000    | 441.00    | BBB40FE1LAQ | 446.00    | BBB40FE2LAQ |
| 450 | 500     | 116.00    | BBB45FE1BAQ | 128.00    | BBB45FE2BAQ |
| 450 | 1000    | 161.00    | BBB45FE1CAQ | 173.00    | BBB45FE2CAQ |
| 450 | 2000    | 250.00    | BBB45FE1EAQ | 262.00    | BBB45FE2EAQ |
| 450 | 3000    | 339.00    | BBB45FE1GAQ | 352.00    | BBB45FE2GAQ |
| 450 | 4000    | 429.00    | BBB45FE1JAQ | 441.00    | BBB45FE2JAQ |
| 450 | 5000    | 518.00    | BBB45FE1LAQ | 531.00    | BBB45FE2LAQ |
| 500 | 1000    | 208.00    | BBB50FE1CAQ | 204.00    | BBB50FE2CAQ |
| 500 | 2000    | 314.00    | BBB50FE1EAQ | 310.00    | BBB50FE2EAQ |
| 500 | 3000    | 420.00    | BBB50FE1GAQ | 416.00    | BBB50FE2GAQ |
| 500 | 4000    | 526.00    | BBB50FE1JAQ | 522.00    | BBB50FE2JAQ |
| 500 | 5000    | 632.00    | BBB50FE1LAQ | 628.00    | BBB50FE2LAQ |
| 600 | 1000    | 292.00    | BBB60FE1CAQ | 342.00    | BBB60FE2CAQ |
| 600 | 2000    | 435.00    | BBB60FE1EAQ | 486.00    | BBB60FE2EAQ |
| 600 | 3000    | 578.00    | BBB60FE1GAQ | 629.00    | BBB60FE2GAQ |
| 600 | 4000    | 722.00    | BBB60FE1JAQ | 772.00    | BBB60FE2JAQ |
| 600 | 5000    | 865.00    | BBB60FE1LAQ | 916.00    | BBB60FE2LAQ |
| 700 | 1000    | 404.00    | BBB70FE1CAQ | 424.00    | BBB70FE2CAQ |
| 700 | 2000    | 578.00    | BBB70FE1EAQ | 598.00    | BBB70FE2EAQ |
| 700 | 3000    | 751.00    | BBB70FE1GAQ | 771.00    | BBB70FE2GAQ |
| 700 | 4000    | 925.00    | BBB70FE1JAQ | 945.00    | BBB70FE2JAQ |
| 700 | 5000    | 1099.00   | BBB70FE1LAQ | 1119.00   | BBB70FE2LAQ |
| 700 | 6000    | 1273.00   | BBB70FE1NAQ | 1293.00   | BBB70FE2NAQ |
| 800 | 1000    | 504.00    | BBB80FE1CAQ | 529.00    | BBB80FE2CAQ |
| 800 | 2000    | 717.00    | BBB80FE1EAQ | 742.00    | BBB80FE2EAQ |
| 800 | 3000    | 930.00    | BBB80FE1GAQ | 956.00    | BBB80FE2GAQ |
| 800 | 4000    | 1143.00   | BBB80FE1JAQ | 1169.00   | BBB80FE2JAQ |
| 800 | 5000    | 1357.00   | BBB80FE1LAQ | 1382.00   | BBB80FE2LAQ |
| 800 | 6000    | 1570.00   | BBB80FE1NAQ | 1595.00   | BBB80FE2NAQ |

|      |         | PN 10     |             | PN 16     |             |
|------|---------|-----------|-------------|-----------|-------------|
| DN   | Lu (mm) | Mass (kg) | References  | Mass (kg) | References  |
| 900  | 1000    | 584.00    | BBB90FE1CAQ | 628.00    | BBB90FE2CAQ |
| 900  | 2000    | 844.00    | BBB90FE1EAQ | 888.00    | BBB90FE2EAQ |
| 900  | 3000    | 1104.00   | BBB90FE1GAQ | 1148.00   | BBB90FE2GAQ |
| 900  | 4000    | 1364.00   | BBB90FE1JAQ | 1408.00   | BBB90FE2JAQ |
| 900  | 5000    | 1624.00   | BBB90FE1LAQ | 1668.00   | BBB90FE2LAQ |
| 900  | 6000    | 1884.00   | BBB90FE1NAQ | 1928.00   | BBB90FE2NAQ |
| 1000 | 1000    | 723.00    | BBC10FE1CAQ | 775.00    | BBC10FE2CAQ |
| 1000 | 2000    | 1035.00   | BBC10FE1EAQ | 1086.00   | BBC10FE2EAQ |
| 1000 | 3000    | 1346.00   | BBC10FE1GAQ | 1398.00   | BBC10FE2GAQ |
| 1000 | 4000    | 1658.00   | BBC10FE1JAQ | 1709.00   | BBC10FE2JAQ |
| 1000 | 5000    | 1969.00   | BBC10FE1LAQ | 2021.00   | BBC10FE2LAQ |
| 1000 | 6000    | 2281.00   | BBC10FE1NAQ | 2332.00   | BBC10FE2NAQ |

## Field of use:

- For drinking water networks

## Main characteristics:

- External **BioZinalium<sup>®</sup>** coating consists of two layers:
  - a layer of zinc-aluminium 85/15 alloy, enriched with copper, with a minimum surface density of 400g/m<sup>2</sup>, applied by spraying molten metal onto the surface of the iron, using an electric arc spray gun, from ZnAl (Cu) alloy wire
  - a protective layer of Aquacoat (semi-permeable), a water-based blue acrylic of average thickness 80 microns applied using a spray gun
- Internal lining: cement mortar
- In conformity with EN 545:2010 and ISO 2531:2009

## Linked products

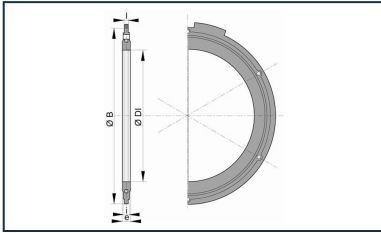

Flanged joint with  
metallized steel bolts and  
nuts

*The information on this sketch is, to the best of our knowledge correct at the time of printing. However Saint-Gobain are constantly looking at ways of improving their products and services therefore reserve the right to change without prior notice, any of the data shown. Any orders placed will be subject to our Standard Conditions of Sale, available on request.*