

Flange Spigot INTEGRAL with Fixed Flange + Weld bead Ve

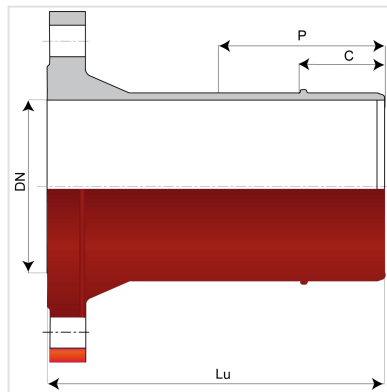

DN (mm)	Lu (mm)	P (mm)	Bead position c	PN 10		PN 16	
				Mass (kg)	References	Mass (kg)	References
700	600	330	158 mm	189.00	*	189.00	*
800	600	330	148 mm	239.00	SSB80BV10FF	250.00	SSB80BV20FF
900	600	330	155 mm	287.00	SSB90BV10FF	298.00	SSB90BV20FF
1000	600	330	165 mm	354.00	SSC10BV10FF	376.00	SSC10BV20FF
1200	600	330	170 mm	469.00	SSC12BV10FF	526.00	*

(*) please contact us

Field of use:

- Separate sewer system and combined sewer system
- Application: gravity flow and rising main sewerage systems
- Type of effluent: domestic wastewater and rainwater
- For networks with rising main under pressure
- For effluents between pH1 and pH13

Main characteristics:

- External and internal coating: red epoxy powder 250µm (PECR)
- EN 598 / CE Marking
- Declaration of performances [DoP-INTEGRAL005EN](#)
- Designed according to the regulatory texts:
 - NF EN 476: general prescriptions for components used in the networks
 - NF EN 752: Conception of sewage projects
 - NF EN 1610: Reception of the works
 - CCTG: Fascicule 70 (sewage work)

Linked products

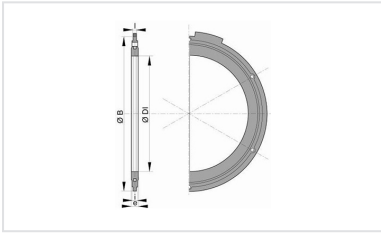

Flanged joint with hot galvanized steel bolts, nuts and washers for sewage

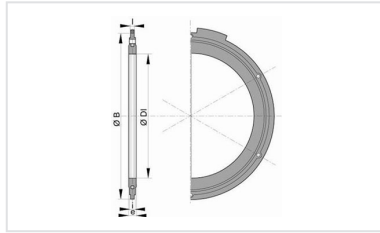

Flanged joint with hot galvanized steel bolts, nuts and washers

The information on this sketch is, to the best of our knowledge correct at the time of printing. However Saint-Gobain are constantly looking at ways of improving their products and services therefore reserve the right to change without prior notice, any of the data shown. Any orders placed will be subject to our Standard Conditions of Sale, available on request.