

## ¼ turn locks

Penta

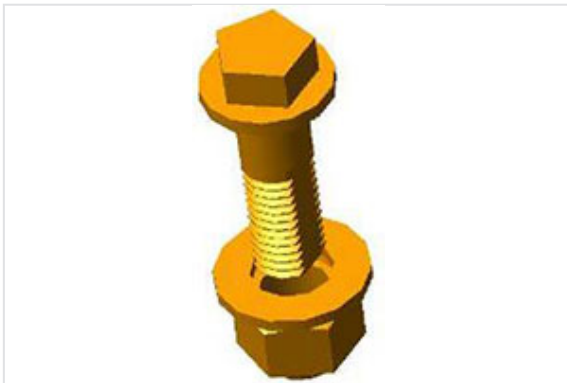

Hexa



SCS



The ¼ turn locks are provided in the form of kits enabling to equip manhole covers and gratings on site.



Stainless steel



Ductile iron

| Type of bars<br>Type of head of handling<br>Products | Stainless steel   |                     |                     | Ductile iron        |                      |
|--|---|---------------------|---------------------|---------------------|----------------------|
|  | Penta   | SCS                 | Hexa                | Penta               | SCS                  |
|  | Notices   | Notices             | Notices             | Notices             | Notices              |
| PAMREX 600 / PAMREX 700 / VIATOP 700                 | <a href="#">C6</a> brass or <a href="#">C62</a> stainless steel | <a href="#">C8</a>  | <a href="#">C60</a> | <a href="#">C56</a> | <a href="#">C58</a>  |
| VIATOP M STANDARD and NIVEAU                         | <a href="#">C34</a>   | <a href="#">C36</a> |                     |                     |                      |
| PAMREX 800 / VIATOP 800 / AMBER / DYNATOP 2          | <a href="#">C14</a>   | <a href="#">C16</a> |                     | <a href="#">C76</a> | <a href="#">C78</a>  |
| REXESS / REXEL1 / REXEL2 G-TEX / TEK / B-TEC         | <a href="#">C10</a>   | <a href="#">C12</a> | <a href="#">C61</a> | <a href="#">C54</a> | <a href="#">C101</a> |
| R-TEX  | <a href="#">C10</a>   | <a href="#">C12</a> |                     | <a href="#">C54</a> | <a href="#">C101</a> |
| Grating DEDRA 600                                    | <a href="#">C6</a> brass or <a href="#">C62</a> stainless steel | <a href="#">C8</a>  | <a href="#">C60</a> |                     |                      |



Key PENTA



Key SCS

**Note:**

- The operating keys are to be ordered separately
- The Hexa ¼ turn lock is handled with a Ø 17 mm universal wrench (not included)

| Handling keys | Key PENTA | Key SCS |
|---------------|-----------|---------|
|               | C17       | C18     |

*The information on this sketch is, to the best of our knowledge correct at the time of printing. However Saint-Gobain are constantly looking at ways of improving their products and services therefore reserve the right to change without prior notice, any of the data shown. Any orders placed will be subject to our Standard Conditions of Sale, available on request.*