

## Flanged Bellmouth (PECB) with Fixed Flange

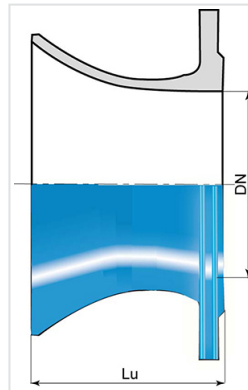

DN (mm)	Lu (mm)	PN 10		PN 16	
		Masse (kg)	References	Masse (kg)	References
300	210	28.00	BBB30BP10TT	30.00	BBB30BP20TT
500	300	109.00	BBB50BP10TT	83.00	BBB50BP20TT
600	300			122.00	BBB60BP20TT
700	500	276.00	BBB70BP10TT	259.00	BBB70BP20TT
800	380	283.00	BBB80BP10TT	283.00	BBB80BP20TT
900	390	239.00	BBB90BP10TT	239.00	BBB90BP20TT
1200	470	460.00	BBC12BP10TT	515.00	BBC12BP20TT

### Field of use:

- For drinking water networks

### Main characteristics:

- External and internal coating : Blue epoxy powder 250 microns average thickness with a minimum of 200 microns, conforming to EN 14901 (PECB)
- In conformity with EN 545:2010 and ISO 2531:2009

## Linked products

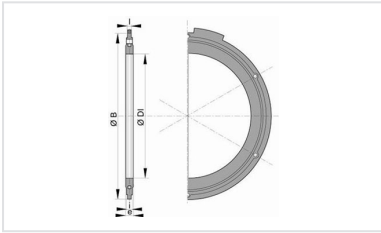

Flanged joint with hot  
galvanized steel bolts, nuts  
and washers

*The information on this sketch is, to the best of our knowledge correct at the time of printing. However Saint-Gobain are constantly looking at ways of improving their products and services therefore reserve the right to change without prior notice, any of the data shown. Any orders placed will be subject to our Standard Conditions of Sale, available on request.*