

## Flange Spigot (PECB) with Rotatable Flange + Weld bead Ve

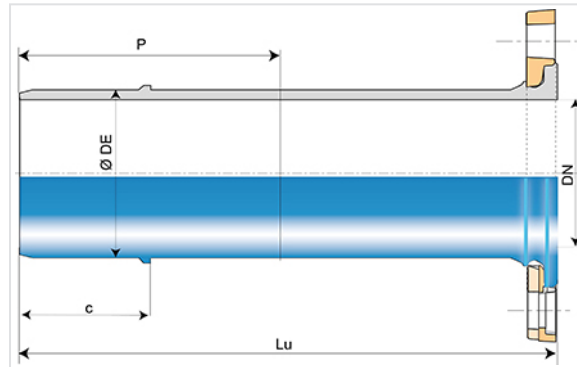

DN (mm)	Lu (mm)	P (mm)	Bead position c (mm)	PN 10		PN 16		PN 25	
				Mass (kg)	References	Mass (kg)	References	Mass (kg)	References
100	350	215	90	9.60	SSB10BV10TT				
200	400	230	100	24.50	SSB20BV10TT	24.00	SSB20BV20TT	25.50	SSB20BV30TT
300	450	250	115	47.00	SSB30BV10TT			50.00	SSB30BV30TT
450	495	280	120					118.00	SSB45BV30TT
600	560	310	135	144.00	SSB60BV10TT			190.00	SSB60BV30TT

### Field of use:

- For drinking water networks

### Main characteristics:

- External and internal coating : Blue epoxy powder 250 microns average thickness with a minimum of 200 microns, conforming to EN 14901 (PECB)
- In conformity with EN 545:2010 and ISO 2531:2009

## Linked products

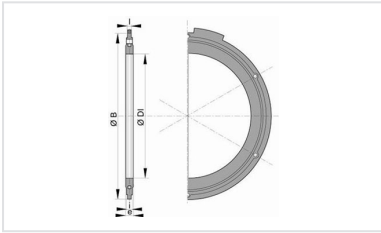

Flanged joint with hot  
galvanized steel bolts, nuts  
and washers

*The information on this sketch is, to the best of our knowledge correct at the time of printing. However Saint-Gobain are constantly looking at ways of improving their products and services therefore reserve the right to change without prior notice, any of the data shown. Any orders placed will be subject to our Standard Conditions of Sale, available on request.*