

Short Double Flanged Pipe (PECB) with Rotatable Flanges

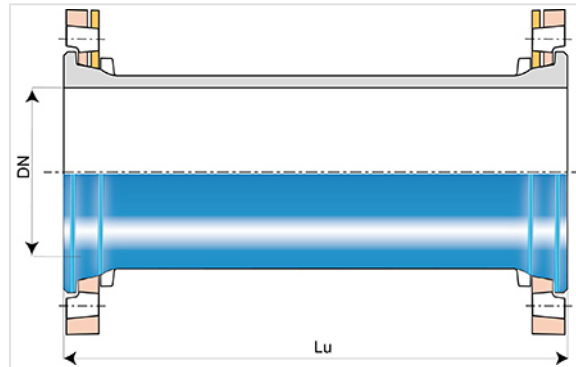

DN (mm)	Lu (mm)	PN 10		PN 16		PN 25		PN 40	
		Mass (kg)	References	Mass (kg)	References	Mass (kg)	References	Mass (kg)	References
60	250	6.60	BAA60MT1ATT	6.60	BAA60MT1ATT	6.60	BAA60MT3ATT	6.60	BAA60MT3ATT
60	500	10.40	BAA60MT1BTT	10.40	BAA60MT1BTT	10.40	BAA60MT3BTT	10.40	BAA60MT3BTT
65	250	8.40	BAA65MT1ATT	8.40	BAA65MT1ATT				
65	500	11.20	BAA65MT1BTT	11.20	BAA65MT1BTT	11.40	BAA65MT3BTT	11.40	BAA65MT3BTT
80	250	9.80	BAA80MT1ATT	9.80	BAA80MT1ATT	9.80	BAA80MT1ATT	9.80	BAA80MT1ATT
80	500	13.30	BAA80MT1BTT	13.30	BAA80MT1BTT	13.30	BAA80MT1BTT	13.30	BAA80MT1BTT
100	250	11.50	BAB10MT1ATT	11.50	BAB10MT1ATT	12.50	BAB10MT3ATT	12.50	BAB10MT3ATT
100	500	15.90	BAB10MT1BTT	15.90	BAB10MT1BTT	14.40	BAB10MT3BTT	14.40	BAB10MT3BTT
125	250	15.00	BAB12MT1ATT	15.00	BAB12MT1ATT	16.70	BAB12MT3ATT	16.70	BAB12MT3ATT
125	500	20.50	BAB12MT1BTT	20.50	BAB12MT1BTT				
150	250	19.00	BAB15MT1ATT	19.00	BAB15MT1ATT	21.00	BAB15MT3ATT	21.00	BAB15MT3ATT
150	500	26.00	BAB15MT1BTT	26.00	BAB15MT1BTT	28.00	BAB15MT3BTT	28.00	BAB15MT3BTT
200	250	26.50	BAB20MT1ATT	26.00	BAB20MT2ATT	29.00	BAB20MT3ATT		
200	500	36.50	BAB20MT1BTT	36.00	BAB20MT2BTT	39.50	BAB20MT3BTT		
250	250	36.80	BAB25MT1ATT2	36.80	BAB25MT2ATT2				
250	500	46.80	BAB25MT1BTT2	46.80	BAB25MT2BTT2	52.00	BAB25MT3BTT2		
300	250	36.60	BAB30MT1ATT2	36.10	BAB30MT2ATT2	39.90	BAB30MT3ATT2		
300	500	60.30	BAB30MT1BTT2	59.30	BAB30MT2BTT2	66.90	BAB30MT3BTT2		
350	250	60.17	BAB35MT1ATT2	62.48	BAB35MT2ATT2	74.24	BAB35MT3ATT2		
350	500	78.75	BAB35MT1BTT2	81.06	BAB35MT2BTT2	92.82	BAB35MT3BTT2		
400	250	71.40	BAB40MT1ATT2	80.85	BAB40MT2ATT2				

DN (mm)	Lu (mm)	PN 10		PN 16		PN 25		PN 40	
		Mass (kg)	References	Mass (kg)	References	Mass (kg)	References	Mass (kg)	References
400	500	93.66	BAB40MT1BTT2	103.11	BAB40MT2BTT2	122.01	BAB40MT3BTT2		
450	250	86.00	BAB45MT1ATT						
450	500	115.00	BAB45MT1BTT	127.50	BAB45MT2BTT				

Field of use:

- For drinking water networks

Main characteristics:

- External and internal coating : Blue epoxy powder 250 microns average thickness with a minimum of 200 microns, conforming to EN 14901 (PECB)
- In conformity with EN 545:2010 and ISO 2531:2009

Linked products

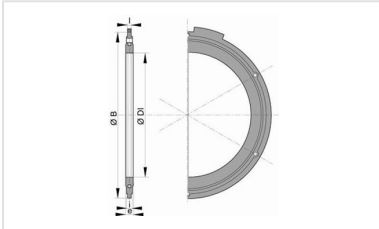

Flanged joint with hot galvanized steel bolts, nuts and washers

The information on this sketch is, to the best of our knowledge correct at the time of printing. However Saint-Gobain are constantly looking at ways of improving their products and services therefore reserve the right to change without prior notice, any of the data shown. Any orders placed will be subject to our Standard Conditions of Sale, available on request.