

## Welded Double Flanged pipe



DN	Lu (mm)	PN 10		PN 16		PN 25	
		Mass (kg)	References	Mass (kg)	References	Mass (kg)	References
60	1000	17.00	BBA60FA1CAQ	17.00	BBA60FA1CAQ		
60	2000	28.00	BBA60FA1EAQ	28.00	BBA60FA1EAQ		
60	3000	39.00	BBA60FA1GAQ	39.00	BBA60FA1GAQ		
60	4000	51.00	BBA60FA1JAQ	51.00	BBA60FA1JAQ		
60	5000	62.00	BBA60FA1LAQ	62.00	BBA60FA1LAQ		
80	1000	23.00	BBA80FA1CAQ	23.00	BBA80FA1CAQ		
80	2000	38.00	BBA80FA1EAQ	38.00	BBA80FA1EAQ		
80	3000	53.00	BBA80FA1GAQ	53.00	BBA80FA1GAQ		
80	4000	67.00	BBA80FA1JAQ	67.00	BBA80FA1JAQ		
80	5000	82.00	BBA80FA1LAQ	82.00	BBA80FA1LAQ		
100	1000	27.00	BBB10FA1CAQ	27.00	BBB10FA1CAQ	28.30	BBB10FA3CAQ
100	2000	45.00	BBB10FA1EAQ	45.00	BBB10FA1EAQ		
100	3000	63.00	BBB10FA1GAQ	63.00	BBB10FA1GAQ		
100	4000	82.00	BBB10FA1JAQ	82.00	BBB10FA1JAQ		
100	5000	99.00	BBB10FA1LAQ	99.00	BBB10FA1LAQ		
125	1000	34.00	BBB12FA1CAQ	34.00	BBB12FA1CAQ		
125	2000	57.00	BBB12FA1EAQ	57.00	BBB12FA1EAQ		
125	3000	81.00	BBB12FA1GAQ	81.00	BBB12FA1GAQ		
125	4000	104.00	BBB12FA1JAQ	104.00	BBB12FA1JAQ		
125	5000	127.00	BBB12FA1LAQ	127.00	BBB12FA1LAQ		
150	1000	40.00	BBB15FA1CAQ	40.00	BBB15FA1CAQ		
150	2000	67.00	BBB15FA1EAQ	67.00	BBB15FA1EAQ		
150	3000	94.00	BBB15FA1GAQ	94.00	BBB15FA1GAQ	97.00	BBB15FA3GAQ

DN	Lu (mm)	PN 10		PN 16		PN 25	
		Mass (kg)	References	Mass (kg)	References	Mass (kg)	References
150	4000	121.00	BBB15FA1JAQ	121.00	BBB15FA1JAQ		
150	5000	148.00	BBB15FA1LAQ	148.00	BBB15FA1LAQ		
200	1000	65.00	BBB20FA1CAQ	55.00	BBB20FA2CAQ	61.30	BBB20FA3CAQ
200	2000	102.00	BBB20FA1EAQ	93.00	BBB20FA2EAQ	97.00	BBB20FA3EAQ
200	3000	139.00	BBB20FA1GAQ	130.00	BBB20FA2GAQ		
200	4000	176.00	BBB20FA1JAQ	167.00	BBB20FA2JAQ		
200	5000	213.00	BBB20FA1LAQ	203.90	BBB20FA2LAQ		
250	1000	70.00	BBB25FA1CAQ	70.00	BBB25FA2CAQ	80.40	BBB25FA3CAQ
250	2000	115.00	BBB25FA1EAQ	121.40	BBB25FA2EAQ	124.00	BBB25FA3EAQ
250	3000	167.40	BBB25FA1GAQ	169.20	BBB25FA2GAQ	170.00	BBB25FA3GAQ
250	4000	215.20	BBB25FA1JAQ	217.00	BBB25FA2JAQ		
250	5000	252.00	BBB25FA1LAQ	264.80	BBB25FA2LAQ		
300	1000	94.00	BBB30FA1CAQ	94.78	BBB30FA2CAQ	105.30	BBB30FA3CAQ
300	2000	159.00	BBB30FA1EAQ	158.60	BBB30FA2EAQ		
300	3000	220.30	BBB30FA1GAQ	202.00	BBB30FA2GAQ	227.90	BBB30FA3GAQ
300	4000	253.00	BBB30FA1JAQ	255.00	BBB30FA2JAQ		
300	5000	306.00	BBB30FA1LAQ	308.00	BBB30FA2LAQ		
350	1000	131.60	BBB35FA1CAQ	120.00	BBB35FA2CAQ		
350	2000	197.27	BBB35FA1EAQ	205.20	BBB35FA2EAQ	197.00	BBB35FA3EAQ
350	3000	284.40	BBB35FA1GAQ				
350	4000	332.00	BBB35FA1JAQ	318.00	BBB35FA2JAQ		
350	5000	398.00	BBB35FA1LAQ	384.00	BBB35FA2LAQ		
400	1000	155.00	BBB40FA1CAQ	142.00	BBB40FA2CAQ		
400	2000	208.00	BBB40FA1EAQ	218.00	BBB40FA2EAQ	235.00	BBB40FA3EAQ
400	3000	284.00	BBB40FA1GAQ	294.00	BBB40FA2GAQ		
400	4000	426.80	BBB40FA1JAQ	370.00	BBB40FA2JAQ		
400	5000	436.00	BBB40FA1LAQ	446.00	BBB40FA2LAQ		
400	5800	497.00	BBB40FA1NAQ	522.00	BBB40FA2NAQ		
450	1000	148.00	BBB45FA1CAQ	173.00	BBB45FA2CAQ		
450	2000	238.00	BBB45FA1EAQ	262.00	BBB45FA2EAQ	285.00	BBB45FA3EAQ
450	3000	327.00	BBB45FA1GAQ	352.00	BBB45FA2GAQ	374.00	BBB45FA3GAQ
450	4000	416.00	BBB45FA1JAQ	441.00	BBB45FA2JAQ		
450	5000	506.00	BBB45FA1LAQ	531.00	BBB45FA2LAQ		

DN	Lu (mm)	PN 10		PN 16		PN 25	
		Mass (kg)	References	Mass (kg)	References	Mass (kg)	References
450	5800	577.00	BBB45FA1NAQ	620.00	BBB45FA2NAQ		
500	1000	212.00	BBB50FA1CAQ	204.00	BBB50FA2CAQ	244.00	BBB50FA3CAQ
500	2000	318.00	BBB50FA1EAQ	310.00	BBB50FA2EAQ		
500	3000	424.00	BBB50FA1GAQ	416.00	BBB50FA2GAQ		
500	4000	530.00	BBB50FA1JAQ	525.00	BBB50FA2JAQ	562.00	BBB50FA3JAQ
500	5000	636.00	BBB50FA1LAQ	713.33	BBB50FA2LAQ		
500	5800	721.00	BBB50FA1NAQ	734.00	BBB50FA2NAQ		
600	1000	241.00	BBB60FA1CAQ	342.00	BBB60FA2CAQ		
600	2000	385.00	BBB60FA1EAQ	486.00	BBB60FA2EAQ		
600	3000	528.00	BBB60FA1GAQ	629.00	BBB60FA2GAQ	699.00	BBB60FA3GAQ
600	4000	671.00	BBB60FA1JAQ	772.00	BBB60FA2JAQ		
600	5000	815.00	BBB60FA1LAQ	916.00	BBB60FA2LAQ		
600	5800	929.00	BBB60FA1NAQ	1059.00	BBB60FA2NAQ		
700	1000	384.00	BBB70FA1CAQ	424.00	BBB70FA2CAQ		
700	2000	558.00	BBB70FA1EAQ	598.00	BBB70FA2EAQ		
700	3000	731.00	BBB70FA1GAQ	771.00	BBB70FA2GAQ		
700	4000	905.00	BBB70FA1JAQ	945.00	BBB70FA2JAQ		
700	5000	1079.00	BBB70FA1LAQ	1119.00	BBB70FA2LAQ		
700	6000	1253.00	BBB70FA1NAQ	1293.00	BBB70FA2NAQ		
700	6400	1322.00	BBB70FA1TAQ	1362.00	BBB70FA2TAQ		
800	1000	478.00	BBB80FA1CAQ	529.00	BBB80FA2CAQ		
800	2000	691.00	BBB80FA1EAQ	742.00	BBB80FA2EAQ		
800	3000	905.00	BBB80FA1GAQ	956.00	BBB80FA2GAQ		
800	4000	1118.00	BBB80FA1JAQ	1169.00	BBB80FA2JAQ		
800	5000	1331.00	BBB80FA1LAQ	1382.00	BBB80FA2LAQ		
800	6000	1544.00	BBB80FA1NAQ	1595.00	BBB80FA2NAQ		
800	6400	1630.00	BBB80FA1TAQ	1681.00	BBB80FA2TAQ		
900	1000	540.00	BBB90FA1CAQ	628.00	BBB90FA2CAQ		
900	2000	800.00	BBB90FA1EAQ	888.00	BBB90FA2EAQ		
900	3000	1060.00	BBB90FA1GAQ	1148.00	BBB90FA2GAQ		
900	4000	1320.00	BBB90FA1JAQ	1408.00	BBB90FA2JAQ		
900	5000	1580.00	BBB90FA1LAQ	1668.00	BBB90FA2LAQ		
900	6000	1840.00	BBB90FA1NAQ	1928.00	BBB90FA2NAQ		

DN	Lu (mm)	PN 10		PN 16		PN 25	
		Mass (kg)	References	Mass (kg)	References	Mass (kg)	References
900	6400	1945.00	BBB90FA1TAQ	2033.00	BBB90FA2TAQ		
1000	1000	671.00	BBC10FA1CAQ	775.00	BBC10FA2CAQ		
1000	2000	983.00	BBC10FA1EAQ	1086.00	BBC10FA2EAQ		
1000	3000	1294.00	BBC10FA1GAQ	1398.00	BBC10FA2GAQ		
1000	4000	1606.00	BBC10FA1JAQ	1709.00	BBC10FA2JAQ		
1000	5000	1917.00	BBC10FA1LAQ	2021.00	BBC10FA2LAQ		
1000	6000	2229.00	BBC10FA1NAQ	2332.00	BBC10FA2NAQ		
1000	6400	2353.00	BBC10FA1TAQ	2457.00	BBC10FA2TAQ		

### Field of use:

- For drinking water networks

### Main characteristics:

- External BioZinalium<sup>®</sup> coating consists of two layers:
  - a layer of zinc-aluminium 85/15 alloy, enriched with copper, with a minimum surface density of 400g/m<sup>2</sup>, applied by spraying molten metal onto the surface of the iron, using an electric arc spray gun, from ZnAl (Cu) alloy wire
  - a protective layer of Aquacoat (semi-permeable), a water-based blue acrylic of average thickness 80 microns applied using a spray gun
- Internal lining: cement mortar
- In conformity with EN 545:2010 and ISO 2531:2009

### Linked products

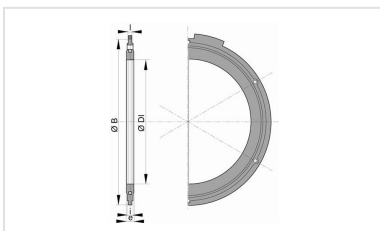

Flanged joint with metallized steel bolts and nuts



# NATURAL SUPPLY, TREATMENT AND DISTRIBUTION DN 60 - 1000

06/06/2026  
WARFP50WEF604

---

*The information on this sketch is, to the best of our knowledge correct at the time of printing. However Saint-Gobain are constantly looking at ways of improving their products and services therefore reserve the right to change without prior notice, any of the data shown. Any orders placed will be subject to our Standard Conditions of Sale, available on request.*