

Welded Double Flanged pipe with Anchor flange (central puddle flange)

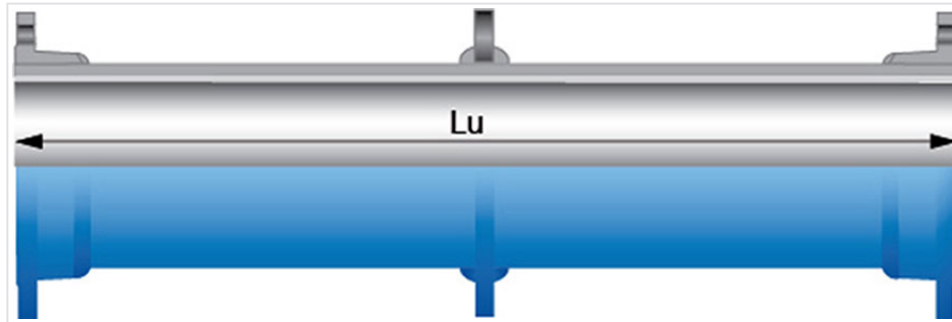

DN	Lu (mm)	PN 10		PN 16		PN 25	
		Mass (kg)	References	Mass (kg)	References	Mass (kg)	References
60	500	13.00	BBA60FD1BAQ	13.00	BBA60FD1BAQ		
60	1000	17.90	BBA60FD1CAQ	17.90	BBA60FD1CAQ		
60	2000	29.00	BBA60FD1EAQ	29.00	BBA60FD1EAQ		
60	3000	40.00	BBA60FD1GAQ	40.00	BBA60FD1GAQ		
60	4000	52.00	BBA60FD1JAQ	52.00	BBA60FD1JAQ		
60	5000	63.00	BBA60FD1LAQ	63.00	BBA60FD1LAQ		
80	500	19.00	BBA80FD1BAQ	19.00	BBA80FD1BAQ		
80	1000	27.00	BBA80FD1CAQ	27.00	BBA80FD1CAQ		
80	2000	42.00	BBA80FD1EAQ	42.00	BBA80FD1EAQ		
80	3000	57.00	BBA80FD1GAQ	57.00	BBA80FD1GAQ		
80	4000	71.00	BBA80FD1JAQ	71.00	BBA80FD1JAQ		
80	5000	86.00	BBA80FD1LAQ	86.00	BBA80FD1LAQ		
100	500	22.00	BBB10FD1BAQ	22.00	BBB10FD1BAQ		
100	1000	28.50	BBB10FD1CAQ	28.50	BBB10FD1CAQ	29.90	BBB10FD3CAQ
100	2000	49.00	BBB10FD1EAQ	49.00	BBB10FD1EAQ		
100	3000	68.00	BBB10FD1GAQ	68.00	BBB10FD1GAQ		
100	4000	86.00	BBB10FD1JAQ	86.00	BBB10FD1JAQ		
100	5000	104.00	BBB10FD1LAQ	104.00	BBB10FD1LAQ		
125	500	28.00	BBB12FD1BAQ	28.00	BBB12FD1BAQ		
125	1000	35.50	BBB12FD1CAQ	35.50	BBB12FD1CAQ		
125	2000	58.00	BBB12FD1EAQ	58.00	BBB12FD1EAQ		
125	3000	80.00	BBB12FD1GAQ	80.00	BBB12FD1GAQ		
125	4000	102.00	BBB12FD1JAQ	102.00	BBB12FD1JAQ		

DN	Lu (mm)	PN 10		PN 16		PN 25	
		Mass (kg)	References	Mass (kg)	References	Mass (kg)	References
125	5000	125.00	BBB12FD1LAQ	125.00	BBB12FD1LAQ		
150	500	34.00	BBB15FD1BAQ	34.00	BBB15FD1BAQ		
150	1000	43.20	BBB15FD1CAQ	43.20	BBB15FD1CAQ	45.80	BBB15FD3CAQ
150	2000	74.00	BBB15FD1EAQ	74.00	BBB15FD1EAQ		
150	3000	101.00	BBB15FD1GAQ	101.00	BBB15FD1GAQ		
150	4000	128.00	BBB15FD1JAQ	128.00	BBB15FD1JAQ		
150	5000	155.00	BBB15FD1LAQ	155.00	BBB15FD1LAQ		
200	500	56.00	BBB20FD1BAQ	46.00	BBB20FD2BAQ	69.00	BBB20FD3BAQ
200	1000	59.90	BBB20FD1CAQ	65.00	BBB20FD2CAQ	69.00	BBB20FD3CAQ
200	2000	111.00	BBB20FD1EAQ	102.00	BBB20FD2EAQ		
200	3000	148.00	BBB20FD1GAQ	139.00	BBB20FD2GAQ		
200	4000	186.00	BBB20FD1JAQ	176.00	BBB20FD2JAQ		
200	5000	223.00	BBB20FD1LAQ	213.00	BBB20FD2LAQ		
250	500	60.00	BBB25FD1BAQ	60.00	BBB25FD2BAQ		
250	1000	82.00	BBB25FD1CAQ	83.00	BBB25FD2CAQ	86.10	BBB25FD3CAQ
250	2000	128.00	BBB25FD1EAQ	128.00	BBB25FD2EAQ		
250	3000	173.00	BBB25FD1GAQ	174.00	BBB25FD2GAQ		
250	4000	219.00	BBB25FD1JAQ	219.00	BBB25FD2JAQ		
250	5000	264.00	BBB25FD1LAQ	265.00	BBB25FD2LAQ		
300	500	88.00	BBB30FD1BAQ	90.00	BBB30FD2BAQ		
300	1000	115.00	BBB30FD1CAQ	103.60	BBB30FD2CAQ	121.00	BBB30FD3CAQ
300	2000	168.00	BBB30FD1EAQ	170.00	BBB30FD2EAQ		
300	3000	221.00	BBB30FD1GAQ	223.00	BBB30FD2GAQ		
300	4000	274.00	BBB30FD1JAQ	276.00	BBB30FD2JAQ		
300	5000	327.00	BBB30FD1LAQ	329.00	BBB30FD2LAQ		
350	500	127.00	BBB35FD1BAQ	113.00	BBB35FD2BAQ		
350	1000	160.00	BBB35FD1CAQ	146.00	BBB35FD2CAQ		
350	2000	226.00	BBB35FD1EAQ	212.00	BBB35FD2EAQ		
350	3000	292.00	BBB35FD1GAQ	278.00	BBB35FD2GAQ		
350	4000	358.00	BBB35FD1JAQ	344.00	BBB35FD2JAQ		
350	5000	424.00	BBB35FD1LAQ	410.00	BBB35FD2LAQ		
400	500	127.00	BBB40FD1BAQ	137.00	BBB40FD2BAQ	154.00	BBB40FD3BAQ
400	1000	165.00	BBB40FD1CAQ	175.00	BBB40FD2CAQ	192.00	BBB40FD3CAQ

DN	Lu (mm)	PN 10		PN 16		PN 25	
		Mass (kg)	References	Mass (kg)	References	Mass (kg)	References
400	2000	241.00	BBB40FD1EAQ	251.00	BBB40FD2EAQ		
400	3000	317.00	BBB40FD1GAQ	327.00	BBB40FD2GAQ		
400	4000	393.00	BBB40FD1JAQ	403.00	BBB40FD2JAQ		
400	5000	469.00	BBB40FD1LAQ	479.00	BBB40FD2LAQ		
450	500	146.00	BBB45FD1BAQ	170.00	BBB45FD2BAQ		
450	1000	190.00	BBB45FD1CAQ	215.00	BBB45FD2CAQ		
450	2000	280.00	BBB45FD1EAQ	304.00	BBB45FD2EAQ		
450	3000	369.00	BBB45FD1GAQ	394.00	BBB45FD2GAQ		
450	4000	458.00	BBB45FD1JAQ	483.00	BBB45FD2JAQ		
450	5000	548.00	BBB45FD1LAQ	572.00	BBB45FD2LAQ		
500	550			204.23	BBB50FD2BAQ		
500	1000	261.00	BBB50FD1CAQ	253.00	BBB50FD2CAQ		
500	2000	367.00	BBB50FD1EAQ	359.00	BBB50FD2EAQ		
500	3000	473.00	BBB50FD1GAQ	465.00	BBB50FD2GAQ		
500	4000	579.00	BBB50FD1JAQ	571.00	BBB50FD2JAQ		
500	5000	685.00	BBB50FD1LAQ	677.00	BBB50FD2LAQ		
600	550			375.90	BBB60FD2BAQ		
600	1000	341.00	BBB60FD1CAQ	442.00	BBB60FD2CAQ		
600	2000	484.00	BBB60FD1EAQ	585.00	BBB60FD2EAQ		
600	3000	627.00	BBB60FD1GAQ	728.00	BBB60FD2GAQ		
600	4000	771.00	BBB60FD1JAQ	872.00	BBB60FD2JAQ		
600	5000	914.00	BBB60FD1LAQ	1015.00	BBB60FD2LAQ		
700	1000	509.00	BBB70FD1CAQ	549.00	BBB70FD2CAQ		
700	2000	683.00	BBB70FD1EAQ	723.00	BBB70FD2EAQ		
700	3000	856.00	BBB70FD1GAQ	896.00	BBB70FD2GAQ		
700	4000	1030.00	BBB70FD1JAQ	1070.00	BBB70FD2JAQ		
700	5000	1204.00	BBB70FD1LAQ	1244.00	BBB70FD2LAQ		
700	6000	1378.00	BBB70FD1NAQ	1418.00	BBB70FD2NAQ		
800	1000	636.00	BBB80FD1CAQ	687.00	BBB80FD2CAQ		
800	2000	849.00	BBB80FD1EAQ	900.00	BBB80FD2EAQ		
800	3000	1063.00	BBB80FD1GAQ	1114.00	BBB80FD2GAQ		
800	4000	1276.00	BBB80FD1JAQ	1327.00	BBB80FD2JAQ		
800	5000	1489.00	BBB80FD1LAQ	1540.00	BBB80FD2LAQ		

DN	Lu (mm)	PN 10		PN 16		PN 25	
		Mass (kg)	References	Mass (kg)	References	Mass (kg)	References
800	6000	1702.00	BBB80FD1NAQ	1753.00	BBB80FD2NAQ		
900	1000	724.00	BBB90FD1CAQ	812.00	BBB90FD2CAQ		
900	2000	984.00	BBB90FD1EAQ	1072.00	BBB90FD2EAQ		
900	3000	1244.00	BBB90FD1GAQ	1332.00	BBB90FD2GAQ		
900	4000	1504.00	BBB90FD1JAQ	1592.00	BBB90FD2JAQ		
900	5000	1764.00	BBB90FD1LAQ	1852.00	BBB90FD2LAQ		
900	6000	2024.00	BBB90FD1NAQ	2112.00	BBB90FD2NAQ		
1000	1000	903.00	BBC10FD1CAQ	1007.00	BBC10FD2CAQ		
1000	2000	1215.00	BBC10FD1EAQ	1318.00	BBC10FD2EAQ		
1000	3000	1526.00	BBC10FD1GAQ	1630.00	BBC10FD2GAQ		
1000	4000	1838.00	BBC10FD1JAQ	1941.00	BBC10FD2JAQ		
1000	5000	2149.00	BBC10FD1LAQ	2252.00	BBC10FD2LAQ		
1000	6000	2461.00	BBC10FD1NAQ	2564.00	BBC10FD2NAQ		

Field of use:

- For drinking water networks

Main characteristics:

- External BioZinalium[®] coating consists of two layers:
 - a layer of zinc-aluminium 85/15 alloy, enriched with copper, with a minimum surface density of 400g/m², applied by spraying molten metal onto the surface of the iron, using an electric arc spray gun, from ZnAl (Cu) alloy wire
 - a protective layer of Aquacoat (semi-permeable), a water-based blue acrylic of average thickness 80 microns applied using a spray gun
- Internal lining: cement mortar
- In conformity with EN 545:2010 and ISO 2531:2009

Linked products

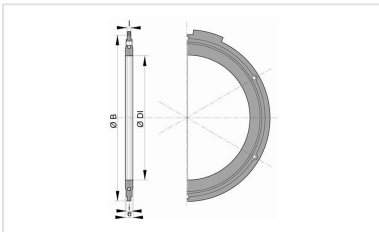

Flanged joint with
metallized steel bolts and
nuts

The information on this sketch is, to the best of our knowledge correct at the time of printing. However Saint-Gobain are constantly looking at ways of improving their products and services therefore reserve the right to change without prior notice, any of the data shown. Any orders placed will be subject to our Standard Conditions of Sale, available on request.