

## Flange Socket (PECB) with socket EXPRESS (and Rotatable Flange or Fixed Flange)

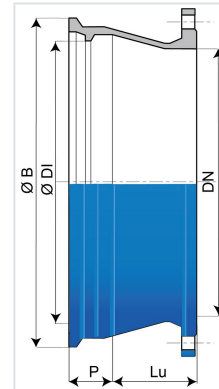
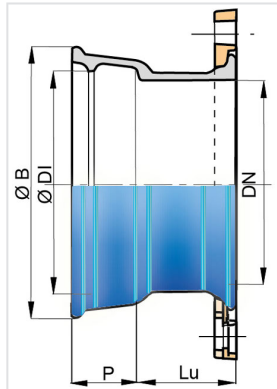

| DN (mm) | Lu (mm) | P (mm) | ØDI (mm) | ØB (mm) | PN 10     |              | PN 16     |              | PN 25     |              | PN 40     |            |
|---------|---------|--------|----------|---------|-----------|--------------|-----------|--------------|-----------|--------------|-----------|------------|
|         |         |        |          |         | Mass (kg) | References   | Mass (kg) | References   | Mass (kg) | References   | Mass (kg) | References |
| 60      | 125     | 76     | 80.3     | 143.5   | 5.60      | 291947       | 5.60      | 291947       |           |              |           |            |
| 80      | 128     | 79     | 101.4    | 167.5   | 7.04      | 290765       | 7.04      | 290765       | 7.04      | 290765       | 7.04      | 290765     |
| 100     | 105     | 80     | 121.4    | 187.5   | 7.14      | 290763       | 7.14      | 290763       |           |              |           |            |
| 125     | 110     | 83     | 147.4    | 214.5   | 9.12      | 293387       | 9.12      | 293387       | 10.79     | 293388       | 10.79     | 293388     |
| 150     | 110     | 86     | 173.4    | 241.5   | 11.06     | 290764       | 11.06     | 290764       |           |              |           |            |
| 200     | 115     | 92     | 225.5    | 294.5   | 18.76     | 290766       | 18.86     | 293339       | 20.06     | 293340       |           |            |
| 250     | 125     | 100    | 276.8    | 351     |           |              | 24.99     | SEB25BE20TT  |           |              |           |            |
| 350     | 130     | 110    | 381.9    | 462     |           |              | 50.82     | SEB35BE20TT2 | 56.70     | SEB35BE30TT2 |           |            |
| 400     | 135     | 110    | 432.9    | 514     | 59.54     | SEB40BE10TT2 | 64.26     | SEB40BE20TT2 | 73.71     | SEB40BE30TT2 |           |            |
| 450     | 140     | 120    | 484      | 575.4   | 71.93     | SEB45BE10TT2 | 76.97     | SEB45BE20TT2 | 87.15     | SEB45BE30TT2 |           |            |
| 500     | 145     | 120    | 536      | 627     | 89.67     | SEB50BE10TT2 | 103.32    | SEB50BE20TT2 | 109.62    | SEB50BE30TT2 |           |            |
| 600     | 155     | 135    | 639.1    | 736.3   | 122.75    | SEB60BE10TT2 | 149.00    | SEB60BE20TT2 | 152.15    | SEB60BE30TT2 |           |            |
| 700     | 190     | 140    | 742      | 861     | 159.00    | SEB70BE10TT  | 167.00    | SEB70BE20TT  | 197.00    | SEB70BE30TT  |           |            |
| 800     | 200     | 140    | 846      | 972     | 205.00    | SEB80BE10TT  | 213.00    | SEB80BE20TT  | 256.00    | SEB80BE30TT  |           |            |
| 900     | 210     | 140    | 949      | 1080    | 248.00    | SEB90BE10TT  | 258.00    | SEB90BE20TT  |           |              |           |            |
| 1000    | 220     | 140    | 1052     | 1189    | 310.00    | SEC10BE10TT  | 327.00    | SEC10BE20TT  | 393.00    | SEC10BE30TT  |           |            |
| 1200    | 240     | 150    | 1259     | 1411    | 451.00    | SEC12BE10TT  | 496.00    | SEC12BE20TT  | 576.00    | SEC12BE30TT  |           |            |

### Field of use:

- For drinking water and irrigation networks
- For aggressive soils (maritime soils, peaty, ...)

### Main characteristics:

- External and internal coating : Blue epoxy powder 250 microns average thickness with a minimum of 200 microns, conforming to EN 14901-1 (PECB)
- In conformity with EN 545:2010 and ISO 2531:2009

### Linked products

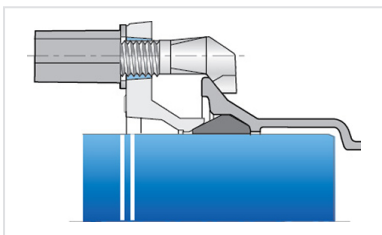

Kit Express Fittings PECB +  
Express Gasket

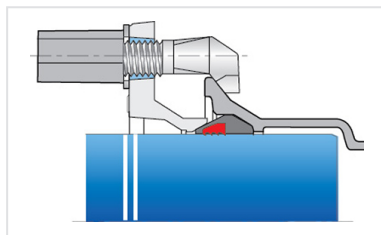

Kit Express Fitting PECB +  
Express Vi Gasket

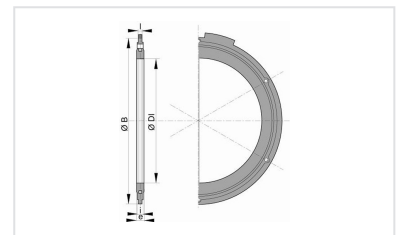

Flanged joint with  
metallized steel bolts and  
nuts

*The information on this sketch is, to the best of our knowledge correct at the time of printing. However Saint-Gobain are constantly looking at ways of improving their products and services therefore reserve the right to change without prior notice, any of the data shown. Any orders placed will be subject to our Standard Conditions of Sale, available on request.*