

Flange Socket (PECB) with socket UNIVERSAL STANDARD and Fixed Flange

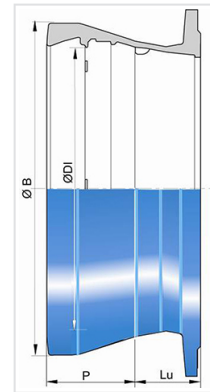
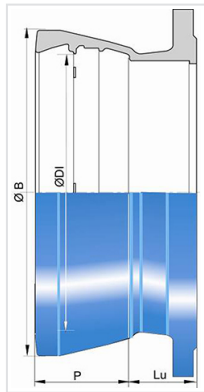

DN (mm)	Lu (mm)	P (mm)	ØDI (mm)	ØB (mm)	PN 10		PN 16		PN 25	
					Mass (kg)	References	Mass (kg)	References	Mass (kg)	References
700	190	256	740.5	857	310.00	SFB70BE10TT	259.00	SFB70BE20TT	289.00	SFB70BE30TT
800	200	261	845.8	983.8	330.00	SFB80BE10TT	385.00	SFB80BE20TT	450.00	SFB80BE30TT
900	210	275	948.9	1093	553.00	SFB90BE10TT	533.00	SFB90BE20TT	615.00	SFB90BE30TT
1000	220	272.5	1052	1216	533.00	SFC10BE10TT	550.00	SFC10BE20TT	616.00	SFC10BE30TT
1100	230	284	1157.1	1311.5	685.00	SFC11BE10TT				
1200	240	279.5	1260	1419.6	679.00	SFC12BE10TT	720.00	SFC12BE20TT	801.00	SFC12BE30TT
1400	310	330	1468.5	1650.1	1069.00	SFC14BE10TT	1121.00	SFC14BE20TT	1250.00	SFC14BE30TT
1600	330	330	1674.2	1876	1376.00	SFC16BE10TT	1439.00	SFC16BE20TT		

Field of use:

- To use under high to very high pressures

Main characteristics:

- External and internal coating : Blue epoxy powder 250 microns average thickness with a minimum of 200 microns, conforming to EN 14901-1 (PECB)
- In conformity with EN 545:2010 and ISO 2531:2009

Linked products

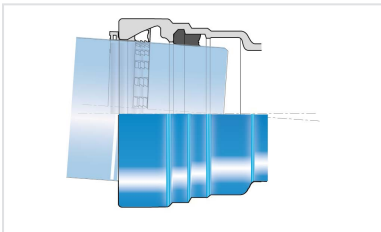

Kit Universal Standard
Fitting PCB + Universal
Standard Vi Joint

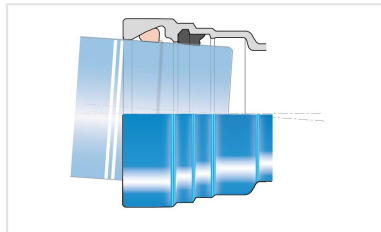

Kit Universal Standard
Fitting PCB + Universal
Standard Ve Joint

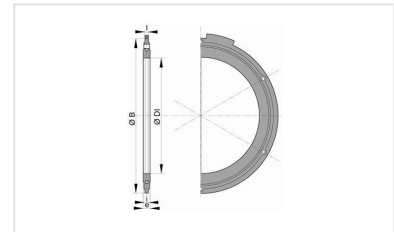

Flanged joint with hot
galvanized steel bolts, nuts
and washers for sewage

The information on this sketch is, to the best of our knowledge correct at the time of printing. However Saint-Gobain are constantly looking at ways of improving their products and services therefore reserve the right to change without prior notice, any of the data shown. Any orders placed will be subject to our Standard Conditions of Sale, available on request.