

## Flange Socket (PECB) with socket PAMLOCK and Fixed Flange

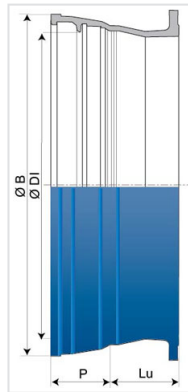

DN (mm)	Lu (mm)	P (mm)	ØDI (mm)	ØB (mm)	PN 10		PN 16		PN 25	
					Mass (kg)	References	Mass (kg)	References	Mass (kg)	References
1400	310	300	1467.1	1633.7	740.00	SPC14BE10TT	792.00	SPC14BE20TT	921.00	SPC14BE30TT
1500	443	322	1570.3	1759.3			1060.00	SPC15BE20TT		
1600	330	325	1673.4	1870.4	1076.00	SPC16BE10TT	1159.00	SPC16BE20TT		
1800	475	350	1880.7	2075.3	1588.00	SPC18BE10TT				
2000	457.5	394	2088	2313	1908.00	SPC20BE10TT				

### Field of use:

- For drinking water and irrigation networks

### Main characteristics:

- External and internal coating : Blue epoxy powder 250 microns average thickness with a minimum of 200 microns, conforming to EN 14901-1 (PECB)
- In conformity with EN 545:2010 and ISO 2531:2009

## Linked products

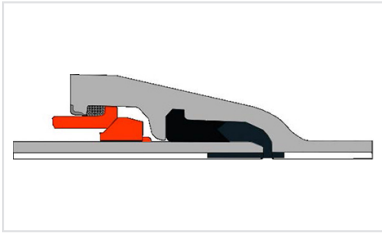

Kit PAMLOCK Fitting PECB +  
PAMLOCK Joint

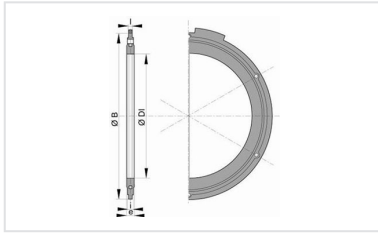

Flanged joint with hot  
galvanized steel bolts, nuts  
and washers

*The information on this sketch is, to the best of our knowledge correct at the time of printing. However Saint-Gobain are constantly looking at ways of improving their products and services therefore reserve the right to change without prior notice, any of the data shown. Any orders placed will be subject to our Standard Conditions of Sale, available on request.*