

## Flange Socket NATURAL with socket EXPRESS and Rotatable Flange

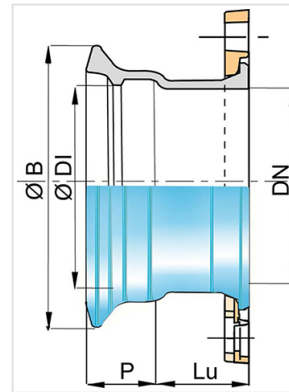
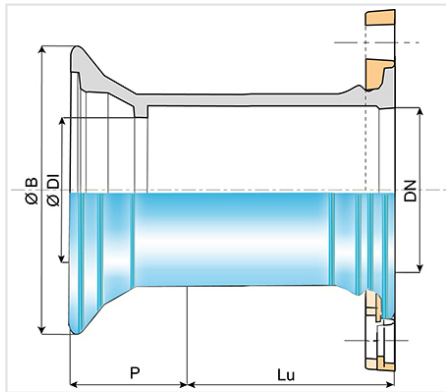

DN (mm)	Lu (mm)	P (mm)	ØDI (mm)	ØB (mm)	PN 10		PN 16		PN 25		PN 40	
					Mass (kg)	References	Mass (kg)	References	Mass (kg)	References	Mass (kg)	References
60	126	76	80.3	143.5	5.67	NEA60BE10NN2	5.67	NEA60BE10NN2	5.70	NEA60BE30NN2	5.70	NEA60BE30NN2
65					6.26	NEA65BE10NN2	6.26	NEA65BE10NN2	6.70	NEA65BE30NN2	6.70	NEA65BE30NN2
80	128	79	101.4	167.5	7.37	NEA80BE10NN2	7.37	NEA80BE10NN2	7.37	NEA80BE10NN2	7.37	NEA80BE10NN2
100	105	80	121.4	187.5	6.45	NEB10BE10NN2	6.45	NEB10BE10NN2	7.65	NEB10BE30NN2	7.65	NEB10BE30NN2
125	110	83	147.4	214.5	8.43	NEB12BE10NN2	8.43	NEB12BE10NN2	10.10	NEB12BE30NN2	10.10	NEB12BE30NN2
150	110	86	173.4	241.5	10.29	NEB15BE10NN2	10.29	NEB15BE10NN2	12.33	NEB15BE30NN2	12.33	NEB15BE30NN2
200	115	92	225.5	294.5	16.25	NEB20BE10NN2	16.15	NEB20BE20NN2	17.65	NEB20BE30NN2		
250	125	100	276.8	351	25.40	NEB25BE10NN2	25.00	NEB25BE20NN2	27.90	NEB25BE30NN2		
300	130	105	328.8	408.2	32.50	NEB30BE10NN2	31.80	NEB30BE20NN2	35.40	NEB30BE30NN2		

### Field of use:

- For drinking water networks
- The scope of use of Aquacoat® fittings in soils is equivalent to that of Natural Biozinalium® pipes, it is suitable for the majority of soils, as defined in appendix D.2.2 of standard EN545:2010. exception :
  - peaty and acidic soils
  - soils containing waste, ashes, slag or contaminated by certain waste or industrial effluents
  - soils located below the level of the marine water table having a resistivity less than 500 Ω cm
- In such soils, or in other aggressive environments, or in the event of stray currents, it is recommended to use other, more suitable types of coatings.

## Main characteristics:

- Inside-Outside coating: Aquacoat fittings (AQB) without Bisphenol
- In conformity with EN 545:2010 and ISO 2531:2009

## Linked products

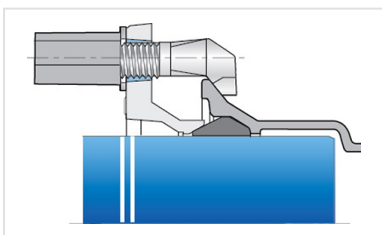

Kit Express Fittings AQB +  
Express Gasket

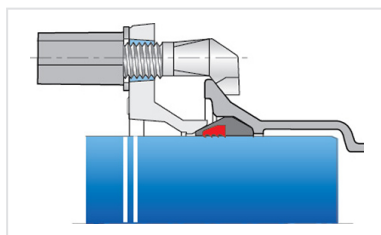

Kit Express Fitting AQB +  
Express Vi Gasket

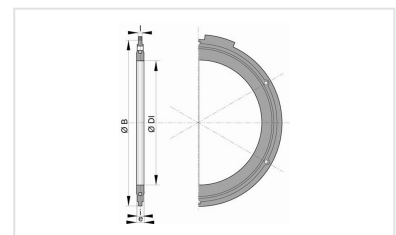

Flanged joint with  
metallized steel bolts and  
nuts

*The information on this sketch is, to the best of our knowledge correct at the time of printing. However Saint-Gobain are constantly looking at ways of improving their products and services therefore reserve the right to change without prior notice, any of the data shown. Any orders placed will be subject to our Standard Conditions of Sale, available on request.*